



CITY OF KEENE
NEW HAMPSHIRE

Trustees of Trust Funds

AGENDA

City Hall 3rd Floor Conference Room
January 15, 2025
9:30 AM

Martha Curtis, Chairman
Marilyn Gemmell, Vice Chairman
Michelle Howard
Allen Mendelson
Malcolm Katz

-
1. Election of Trustee of Trusts Fund & Cemetery Trust Chairman and Vice Chairman
 2. Approval of the December 2024 minutes
 3. Periodic Review of Trusts and Capital Reserves- Cambridge Trust presenting in person
 - Susan Martore-Baker, President of Cambridge Trust, NH
 - Eric Jussaume, Sr Vice President
 - Lisa Tourangeau, Relationship Manager
 4. Common Trust Fund
 - a. Use of Funds – Request from Carrah Fisk-Hennessey, Parks & Rec Director to purchase pins and lot markers
 - b. Approval of Receipts –
 - i. Cemetery Lot Sales July 2024-December 2024 **\$3,600.00**
 - #968 Cemetery Trust Fund A – Perpetual Care of Cemeteries = \$1,800.00
 - #974 Cemetery Trust Fund B – Cemetery Capital Reserve = \$1,800.00
 - c. Approval of Disbursements – **\$1,357.12**
 - i. #936 Ashuelot River Park Trust - \$357.12
 - Dian Mathews (Garden Kit)- \$217.12
 - Gemgraphics - \$140.00
 - ii. #908 Police Benevolent Fund \$1,000.00
 - Annual contribution for maintenance and replacement equipment
 5. Capital Reserve Portfolio
 - a. Approval of Receipts
 - i. None
 - b. Approval of Disbursements – **\$84,092.46**
 - i. #800 Ambulance Capital Reserve = \$34,259.90
 - ii. #810 Downtown Infrastructure and Facility Capital Reserve = \$644.81

- iii. #812 Transportation Improvement = \$27,531.10
- iv. #822 Parks & Facilities Infrastructure = \$420.00
- v. #830 Martel Court Pumping Station = \$2,598.55
- vi. #834 Sewer Infrastructure Capital Reserve = \$16,718.60
- vii. #842 Water Infrastructure Capital Reserve = \$1,919.50

6. Distribution of MS9 for the period ending December 31, 2024.

- a. Common Trust Funds
- b. Capital Reserve Funds

7. Updates/Future Items

- a. 2025 Scholarships
- b. Periodic Review of Trusts and Capital Reserves – Cambridge Trust
 - i. April 16, 2025 – Cambridge Trust electronic review
- c. Review of Trust Fund Overview
 - i. #918 Serena W Upton Fund
 - ii. #916 Maria Giffin Charitable Fund
 - iii. #920 / #948 George B Elliot Charitable Fund

**City of Keene
NEW HAMPSHIRE**

**TRUSTEES OF TRUST FUNDS
MEETING MINUTES**

Wednesday, December 18, 2024 9:30 AM City Hall-3rd Floor Conference Room

Members Present:

Marilyn Gemmell
Michelle Howard
Allen Mendelson
Jennie Newcombe

Staff Present:

Sherry Miller, Senior Staff Accountant

Absent:

Martha Curtis

Other:

In the absence of Chair Curtis, Vice Chair Gemmell called the meeting to order at 9:35 AM with Trustees Gemmell, Howard, and Newcombe present. Trustee Mendelson joined the meeting at 9:40 a.m.

APPROVAL OF MINUTES

Trustee Newcombe made a motion to approve the minutes of the November 20, 2024 meeting as presented, Trustee Howard seconded. Motion carried unanimously.

COMMON TRUST FUNDS

APPROVAL FOR USE OF FUNDS –

None

RECEIPTS

None

DISBURSEMENTS

None

CAPITAL RESERVES

RECEIPTS

None.

DISBURSEMENTS

Vice Chair Gemmell presented disbursements totaling \$628,037.26 noting that the funds are reimbursing the City of Keene for the period November 1, 2024 - November 30, 2024. Supporting documentation was presented for the Trustees review.

- #806 Bridge Capital Reserve = \$53,993.16
- #810 Downtown Infrastructure and Facility = \$181,550.16
- #812 Transportation Improvement = \$49.64
- #814 Road & Sidewalk Infrastructure = \$17,143.96
- #820 IT System & Infrastructure = \$7,809.45

- #822 Parks & Facilities Infrastructure = \$94,900.60
- #832- Wastewater Treatment Plant Reserve = \$67,617.96
- #834 Sewer Infrastructure = \$7,077.53
- #840 Water Treatment Plant = \$20,069.88
- #842 Water Infrastructure = \$127,769.84
- #860 Fleet Equipment = \$50,055.08

Trustee Howard made a motion to approve the disbursements as presented. Trustee Newcombe seconded. Motion carried unanimously.

DISTRIBUTION OF MS9S

Vice Chair Gemmell asked if there were any questions on the MS9 reports for the Common Trust and Capital Reserves for the period ending November 30, 2024. No questions were asked.

UPDATES/FUTURE ITEMS

Trustee Mendelson made a motion to nominate Malcolm Katz to serve a term on the Trustee of the Trust Funds. Trustee Howard seconded. Motion carried unanimously.

The Trustees had a short discussion with the mayor regarding who nominates and appoints new Trustees and potential alternates.

The Trustees discussed reviewing scholarship information at their January meeting. A suggestion was made to have someone from the school come to a meeting to present recipients.

Periodic review of the Trusts and Capital Reserve by Cambridge Trust will be according to the following schedule:

- January 15, 2025 – In person presentation at 9:30 AM (this will be weather permitting, otherwise a video call)
- April 2025 – TBA Video presentation
- July 2025 – TBA in person presentation

A review of the Trust Fund documents was tabled for a future meeting.

The meeting adjourned at 10:25 AM.

Respectfully submitted,
Sherry Miller



DATE: December 30, 2024

TO: Trustees of Trust Funds

THROUGH: Sherry Miller, Senior Staff Accountant

FROM: Carrah Fisk-Hennessey, Parks & Recreation Director

SUBJECT: Cemetery Pin/Lot Markers Purchase Request

RECOMMENDATION:

We request that the Trustees of Trust Funds finance the purchase of new placement pins for the recently approved cremation lots within the existing mapping of Monadnock View Cemetery. Attached is a quote for custom-poured aluminum pins/lot markers in the amount of \$555.77 (54 pins for 27 lots).

BACKGROUND:

In November, the Trustees granted permission to expand cremation burial opportunities within existing mapping of Monadnock View Cemetery. The approved plan, as listed below, is a small-scale expansion to accommodate the current needs of our community in anticipation of the larger scale cemetery expansion project in the near future.

Section B = 27 lots in a 65' x 20' space → Pricing for 54 pins = \$555.77 (quoted, incl. S&H)

Section C = 45 lots in a 60' x 40' space → Pricing for 90 pins = \$1080.00 (estimate)

Section H = 70 lots in a 204' x 20' space → Pricing for 140 pins = \$1680.00 (estimate)

Considering that the larger scale expansion of Monadnock View Cemetery has already been awarded and earmarked funding by the Trustees and that the Request for Proposals has been submitted by the City of Keene Purchasing Office, we would like to secure funding for only the Section B additional pin/lot markers at this time – a total request of \$555.77.

We plan to bring the Trustees approval of additional lots to City Council for final approval in January. After City Council approval, we will follow the directive written in city code: “Before any new block of a municipal cemetery is opened for the sale of lots, the director shall cause it to be platted and recorded in the city clerk’s office.” (Section 22-61). We anticipate opening the newly added Section B cremation lots for sale in February and will meet with the Board of Trustees again should we require additional short-term expansion space before the larger-scale expansion plan and timeframe are set.

Attached: Section B additional lot map, American Cemetery Supplies, Inc. quote

Monadnock View Cemetery Section B

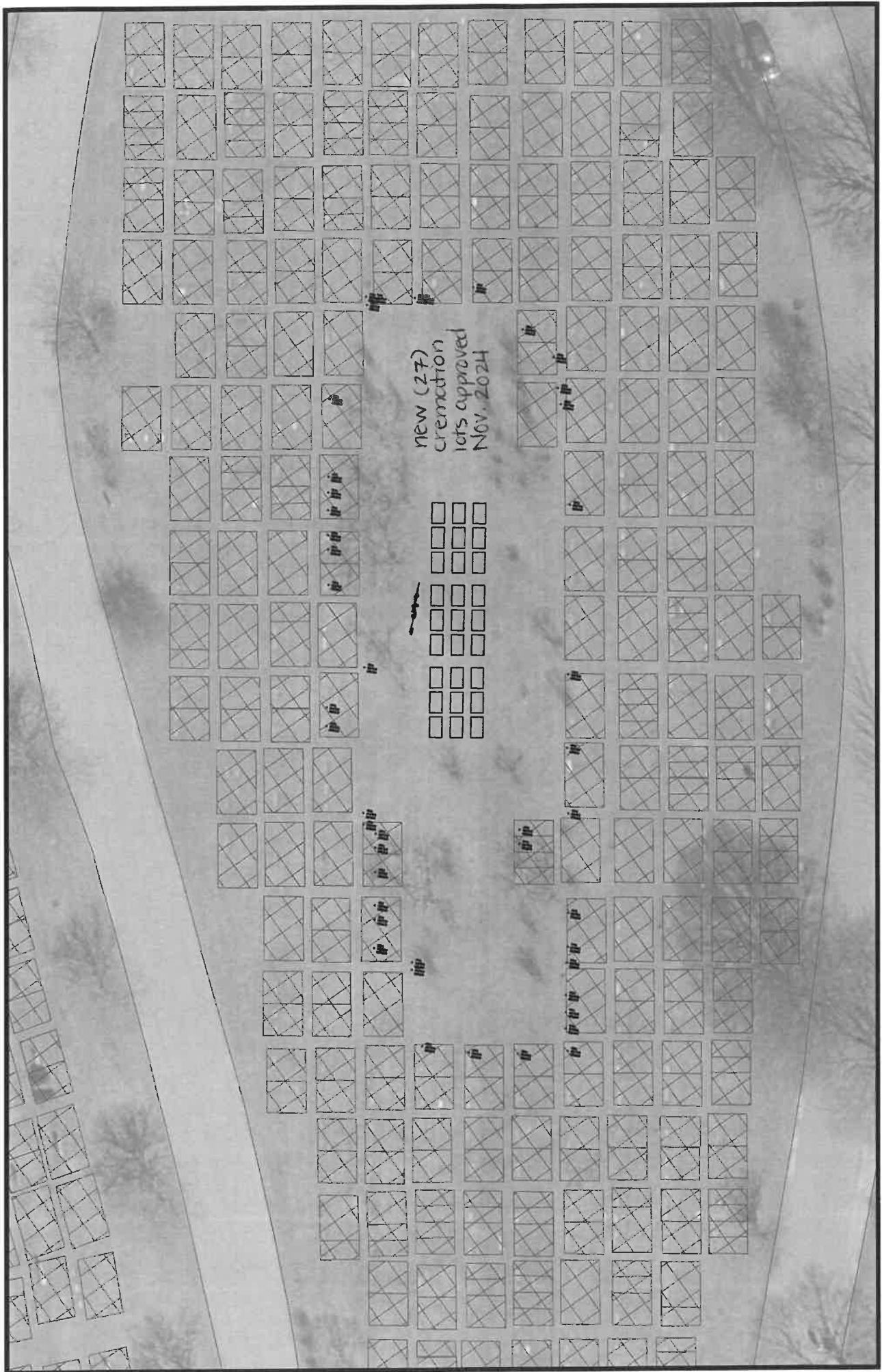

American Cemetery Supplies, Inc.

2001 Laigh Road
 Portsmouth, VA 23701
 Phone: (800) 515-0400 Fax: (757) 488-1589

Sales Order# 074810

Account ID 03431--KEE	Contact Frank Anderson	
Customer PO None	Telephone (603) 357-9829	Facsimile (603) 283-5661

Bill To:

Keene Parks & Recreation
 312 Washington St.
 Keene, NH 03431

Ship To:

Keene Parks & Recreation
 312 Washington St.
 Keene, NH 03431

ATTENTION! - This is an Order Confirmation. Please Check the Line Items for Accuracy

Special Order Drop Ship

Order Date 12/31/2024	Comments Lot Markers**QUOTE**		Special Instructions Please pay by invoice.			Terms NET 30	
Ship Via NONE	Date Required 12/31/2024	FOB Factory	From Quote#		Salesperson Liz S		
Ordered	Shipped	Open	Item# Description	UOM	Date Required	Price	Total
54	0	54	81051 Lot Markers Cast Alum LS 4"w/ 8" Spike <i>Style E4. Marker has a 4" round top, with 8" integrally cast steel spike. No lettering included in this price. See ACS product #81083.</i>	EACH	12/31/2024	\$8.530	\$460.62
138	0	138	81083 Lot Marker Lettering "LS style" <i>Per digit. **C1- C-27 (X2) 2 of Each letter and number** **See attached**</i>	EACH	12/31/2024	\$0.250	\$34.50

Comments

Merchandise is Shipped F.O.B. factory shipping will be added upon completion. Payment in Full is required by Terms set forth above. We retain full interest of Product until full payment has been received. A 1.5% finance charge compounded monthly shall be assessed against any balance considered past due. Past due balances which go to collection will have a 25% collection fee added. Customer/Purchaser is responsible for any and all costs for collection.

Sub Total	\$495.12
0% Tax	\$0.00
Freight	\$60.65
Grand Total	\$555.77
Deposit	\$0.00
Balance	\$555.77

**City of Keene, New Hampshire Trust Funds
Deposit to Common Trust Funds - TO PRINCIPAL**

Date: 1/15/2025
To: Trustees of Trust Funds
From: Sherry Miller, Senior Staff Accountant
RE: Deposit to Principal

Trust #	Title of Trust	Purpose	Amount
968	Cemetery Trust A - Perpet Care	1/2 Cemetery Lot Sales (July 2024-december 2024)	1,800.00
974	Cemetery Trust B - Cap Reserve	1/2 Cemetery Lot Sales (July 2024 - December 2024)	1,800.00
Total Deposit Request			3,600.00

Amount of Deposit: \$3,600.00

Account to be Credited: City of Keene - Common Fund

Payable To: Trustees of Trust Funds
c/o Cambridge Trust Company

Approved By Trustees:

X _____
X _____
X _____
X _____
X _____

**CITY OF KEENE
NEW HAMPSHIRE
Check Request**

Date: 01/3/2025

Check Payable to: Trustees of Trust Funds

Amount: \$3,600.00

Account to charge: 00000010 213010

Explanation: Cemetery lot sales for the period July 1, 2024 – December 31, 2024

Requested By: Sherry Miller 01.03.2025

Authorized Approval: Andrew [Signature] 1/3/25

December 31, 2024

List of plot sales billed out for but not fully paid

William Stevens \$800.00

Ross Williams \$314.00

Mary Gagne \$400.00

Elizabeth Laroche \$400.00

Catherine Blair \$400.00

Total \$2314.00

Balance in 00000010-213010 \$5914.00

Check Request \$3600.00

**City of Keene, New Hampshire Trust Funds
Disbursement Request - FROM INCOME**

Date: 1/15/2025
To: Trustees of Trust Funds
From: Sherry Miller, Senior Staff Accountant
RE: Disbursement Request from Income

Trust #	Title of Trust	Purpose	Amount
936	Ashuelot River Park Trust	65M00224 -2025 Budget -	357.12
		Reimbursement to City of Keene	
		Dian Mathews Reimb Garden Kit	217.12
		Gemgraphics -Event Signs	140.00
Total Withdrawal Request			357.12

**Amount of
Withdrawal:** \$357.12

**Account to be
Charged:** City of Keene - Common Fund

ACH Funds To: Mascoma Bank

Approved By Trustees:

X _____
 X _____
 X _____
 X _____
 X _____



DATE:

November 12, 2024

CHECK PAYABLE TO:

Dian Mathews
625 West Street
Keene, NH 03431

AMOUNT: \$217.12

CODE: 65M00224-300-0-523400

EXPLANATION:

Reimbursement for credit card purchase of 50-plant pollinator garden kit for Ashuelot River Park.

PLEASE MAIL CHECK directly to Dian at the address listed above.

APPROVED: _____

Carrah F. Stennessy
FINANCE DIRECTOR

VENDOR NUMBER	VENDOR NAME	CHECK NUMBER	CHECK DATE	CHECK AMOUNT
16232	DIAN MATHEWS	213912	11/15/2024	\$217.12

INVOICE DATE	INVOICE NUMBER	DESCRIPTION	INVOICE AMOUNT
11/12/2024	11-12-24	REIMB FOR GARDEN KIT GL #: 00000300-523400	\$217.12



CITY OF KEENE
KEENE, NEW HAMPSHIRE

Vendor Number	Check Number	Check Date
16232	213912	11/15/2024

*** Two Hundred Seventeen Dollars And Twelve Cents ***

\$217.12

**FILE COPY
NON-NEGOTIABLE**

Pay To DIAN MATHEWS
The 625 WEST ST
Order Of KEENE, NH 03431

GemGraphics
 Your image is everything
 415 Marlboro Street - Keene, NH 03431
 P: 603-352-7112
 www.gemgraphicsnh.com

65M00224-3760
 300-0-527600
 12/9/24
 (CPA)

Invoice

Date	Invoice #
9/17/2024	56429

Bill To
City of Keene Parks & Recreation Dept 312 Washington Street Keene, NH 03431

Ship To
City of Keene Parks & Recreation Dept 312 Washington Street Keene, NH 03431

P.O. Number	Terms	Ship	Via	Payment Type
Andy	Net 30	9/17/2024		

Item Code	Description	Quantity	Price Each	Amount
Sign	KIP Event Schedule Coreplast 1 Sided Sign 24x36 Qty: 2 each / 2 versions	4	35.00	140.00

<p><i>Thank you for your order. Please make checks payable to: GemGraphics, Inc.</i></p> <p><i>Additional 3% Fee for Credit Card Payments.</i></p>	Total	\$140.00
	Payments/Credits	\$0.00
	Balance Due	\$140.00

Signs - Banners - Vehicle Lettering - Labels - Screenprinting - Printing & Copying - Architectural Copies - Engraving - Logo & Graphic Design

INVOICE: Picked up 9/24 Emailed 9/17 Mailed _____ Shipped _____ CALLED _____ / _____ / _____ BIN # _____

VENDOR NUMBER	VENDOR NAME	CHECK NUMBER	CHECK DATE	CHECK AMOUNT
6074	GEMGRAPHICS, INC	214485	12/20/2024	\$284.00

INVOICE DATE	INVOICE NUMBER	DESCRIPTION	INVOICE AMOUNT
09/17/2024	56429	KIF EVENT SCHEDULE GL #: 00000300-523700	\$140.00
12/04/2024	57148	ARCHITECTUAL PRINTS GL #: 00000300-541020	\$144.00



CITY OF KEENE
KEENE, NEW HAMPSHIRE

Vendor Number	Check Number	Check Date
6074	214485	12/20/2024

*** Two Hundred Eighty-Four Dollars And Zero Cents ***

\$284.00

**FILE COPY
NON-NEGOTIABLE**

Pay To GEMGRAPHICS, INC
The 415 MARLBORO ST
Order Of KEENE, NH 03431

**City of Keene, New Hampshire Trust Funds
Disbursement Request - FROM INCOME**

Date: 1/15/2025
To: Trustees of Trust Funds
From: Sherry Miller, Senior Staff Accountant
RE: Deposit to Principal

Trust #	Title of Trust	Purpose	Amount
908	Police Benevolent	Annual (FY25) contribution for maintenance and equipt replacement	1,000.00
Total Deposit Request			1,000.00

Amount of Withdrawal: \$1,000.00

Account to be Charged: City of Keene - Common Fund #4482

ACH Funds To: Mascoma Bank

Approved By Trustees:

X _____
 X _____
 X _____
 X _____
 X _____

upon application to and recommendation of the Benevolent Trust Relief Review Board, to continue to relieve active members of the KPD, injured in the line of duty, in accordance with the guidelines contained in Exhibit D and the original terms of said Trust. Said Ten Thousand Dollars (\$10,000.00) which is set aside to be maintained with future income earned on the principal balance.

B. To allow that the Trustees be authorized to expend a portion of the income balance not to exceed One Hundred Fifty Thousand Dollars (\$150,000.00), of the Trust to build and equip a gymnasium for use by active members of the KPD.

C. To allow that the Trustees be authorized to expend One Thousand Dollars (\$1,000.00) per year of future income from the Trust, and if not expended in any given year to accumulate said amount for future expenditure, for maintenance of the gymnasium equipment. Said maintenance expenditure may continue in perpetuity or until the gymnasium no longer exists, as long as the City of Keene matches said amount with an equal annual contribution to a non-lapsing special revenue fund to be used for the same purposes.

D. To allow that the Trustees be authorized to expend any remaining future income earned by the Trust, upon application to and recommendation of the Benevolent Trust Relief Review Board, to provide scholarships and tuition reimbursement to active members of the KPD, in addition to any tuition reimbursement that is currently made available to said members, and their dependant children.

**City of Keene, New Hampshire Trust Funds
Withdrawal from Capital Reserves**

Date: 1/10/2025
To: Trustees of Trust Funds
From: Sherry Miller, Senior Staff Accountant
RE: Capital Reserve Withdrawals

Capital Reserve	Purpose of Withdrawal		Amount
#800 Ambulance			34,259.90
40M0002B	Ambulance Replacement Fund	34,259.90	
#810 Downtown Infrastructure & Facility			644.81
75J0034A	Downtown Revitalization	644.81	
#812 Transportation Improvement			27,531.10
65M0008A	Transportation Heritage Trail	27,387.10	
75J0018B	Marlboro St Corridor - Construction	144.00	
#822 Parks and Facilities Infrastructure			420.00
65J0004A	Recreation Center Renovation	420.00	
#830 Martel Court Pumping Station			2,598.55
32JM006A	MC Phase 2 Generator / Transformer	2,598.55	
50M0004A	Server Replacement	7,023.00	
#834 Sewer Infrastructure			16,718.60
32MI0222	FY22 Sewer Imp-Force Main Design	16,718.60	
#842 Water Infrastructure			1,919.50
34JI004A	3.0 MG Water Storage Tank Study	1,919.50	
Total Withdrawal Request			84,092.46

**Amount of
Withdrawal:** \$84,092.46

**Account to be
Charged:** City of Keene - Capital Reserve Fund

ACH Funds To: Mascoma Bank

Approved By Trustees:

X _____
 X _____
 X _____
 X _____
 X _____

Capital Reserve Withdrawal FY25 December 2024 Trustees Meeting														
MUNIS	Munis / Penta CR Fund #	Project Name	Cap Reserve Budget	PENTA FY23 Penta Pd 13 Expense	MUNIS	TOTAL	Revenue Other Sources	NET Exp. Less Other Rev	PENTA Prior Mos Reimb Revenue	MUNIS Prior Mos Reimb Revenue	TOTAL Cumulative CR Drawdowns	REQUEST December Trustees		
40M0002B	800 / 611	300 Ambulance Rejuvenation	452,186.00	0.00	34,259.90	34,259.90	0.00	34,259.90	0.00	0.00	0.00	84,259.90		
40M0002C	800 / 600	300 Fire Dept Tanker Truck	373,374.50	351,625.50	373,374.50	725,000.00	725,000.00	725,000.00	351,625.50	373,374.50	725,000.00	0.00		
40M0002D	802	300 FV23 Brush Truck/Utility Truck	115,000.00	0.00	130,227.76	130,227.76	27,700.00	57,155.38	0.00	0.00	57,155.38	0.00		
40M0002E	806	300 FV23 Resue Truck Refurbishment	524,000.00	0.00	0.00	0.00	0.00	0.00	0.00	0.00	0.00	0.00		
75M0020A	806	300 Bridge-George Over Beaver Bk	456,230.00	0.00	228,993.16	228,993.16	175,000.00	59,993.16	0.00	0.00	59,993.16	0.00		
75M0020C	806	300 Bridge-Winch Over Ash Swamp	334,405.11	0.00	0.00	0.00	0.00	0.00	0.00	0.00	0.00	0.00		
65M0014A	810 / 619	300 / 26 Multi-Modal Hub	1,984,000.00	0.00	641,011.28	641,011.28	641,011.28	0.00	0.00	0.00	640,366.47	644.81		
65M0014B	811	300 / 26 Transportation Heritage Trail	200,725.00	0.00	157,633.22	157,633.22	128,827.85	28,805.37	0.00	0.00	1,418.27	27,887.10		
65M0013A	812	300 / 26 Don Space & Trails Program	100,000.00	0.00	51,767.23	51,767.23	51,767.23	0.00	0.00	0.00	51,767.23	0.00		
65M0004A	812	300 / 52 Chebise Ball Trail Phase 3	71,500.00	0.00	513,027.10	513,027.10	436,415.16	76,601.94	0.00	0.00	76,601.94	0.00		
65M0023A	812	300 Trail Bridge Maintenance	113,000.00	0.00	0.00	0.00	0.00	0.00	0.00	0.00	0.00	0.00		
75M0018A	812 / 620	300 / 26 Mainboro St Corridor - Design	119,189.16	0.00	131,980.16	131,980.16	12,791.00	119,189.16	0.00	0.00	119,189.16	0.00		
75M0022Z	814 / 621	300 / 26 FY22 Roadway Preservation & Rehabilitation	355,105.79	0.00	1,597,236.12	1,597,236.12	1,316,890.21	280,345.91	0.00	0.00	280,345.91	0.00		
75M0022B	814 / 621	300 / 26 FY22 Road Rehabilitation	244,890.21	0.00	825,633.89	825,633.89	753,009.79	72,524.10	0.00	0.00	72,524.10	0.00		
75M0023B	814 / 621	300 / 26 FY22 Road Preservation	150,000.00	0.00	123,915.81	123,915.81	0.00	123,915.81	0.00	0.00	123,915.81	0.00		
75M00043	814 / 621	300 / 26 FY23 Sidewalk Repairs	27,400.00	0.00	260,571.01	260,571.01	22,000.00	238,471.01	0.00	0.00	238,471.01	0.00		
75M00045	814 / 621	300 / 26 FY24 Sidewalk Repairs	290,600.00	0.00	287,697.21	287,697.21	0.00	287,697.21	0.00	0.00	289,105.50	(1,408.29)		
75M00042	814 / 621	300 / 26 FY25 Sidewalk Repairs	289,488.00	0.00	0.00	0.00	0.00	0.00	0.00	0.00	0.00	0.00		
75M00223	814 / 621	300 / 26 FY23 Traffic Signals - West St	190,900.00	0.00	21,087.00	21,087.00	0.00	21,087.00	0.00	0.00	21,087.00	0.00		
70M0004A	816	300 / 26 Police Mobile Radios	176,336.00	0.00	124,915.52	124,915.52	0.00	124,915.52	0.00	0.00	124,915.52	0.00		
10M00021	818 / 623	300 / 26 Assess-FY21 Reevaluation	160,494.90	108,342.04	120,212.04	120,212.04	109,875.10	88,005.10	0.00	0.00	109,875.10	0.00		
50M0022A	820	300 / 26 Phone System Replacement	261,500.00	0.00	241,756.23	241,756.23	241,756.23	0.00	0.00	0.00	241,756.23	0.00		
50M0023A	820 / 624	300 / 26 Network Equipment Replacement	37,500.00	0.00	6,500.00	6,500.00	0.00	6,500.00	0.00	0.00	6,500.00	0.00		
50M0004A	820	300 Server Replacement	72,898.45	0.00	60,744.95	60,744.95	0.00	60,744.95	0.00	0.00	60,744.95	0.00		
50M0004B	820 / 624	300 / 26 FY22 Database Software	44,000.00	0.00	647,470.07	647,470.07	801,250.00	0.00	0.00	0.00	(154,199.93)	431.00		
50M0004A	822	300 / 26 Retention Center Renovation	285,000.00	0.00	0.00	0.00	50,000.00	0.00	0.00	0.00	(50,000.00)	0.00		
65M0001A	822	300 / 26 W Keene Fire Station	135,000.00	0.00	34,477.87	34,477.87	0.00	34,477.87	0.00	0.00	34,477.87	0.00		
65M0001B	822	300 / 26 Robin Hood Park Improve Design	35,000.00	0.00	718,361.62	718,361.62	524,321.72	194,039.90	0.00	0.00	194,039.90	0.00		
65M0000A	822	300 / 26 Municipal Building Capital Maint	235,000.00	0.00	162,506.62	162,506.62	85,568.00	76,938.62	0.00	0.00	76,938.62	0.00		
75M0001B	812	300 / 26 Mainboro St Corridor - Construction	252,447.76	0.00	9,965.86	9,965.86	2,204,566.70	(2,198,498.70)	(555,721.30)	(1,631,921.40)	(2,188,642.70)	144.90		
30M0002A	830 / 607	300 / 32 MC Emergency Plan	10,466.79	34,133.21	44,099.07	44,099.07	0.00	44,099.07	0.00	0.00	44,099.07	0.00		
30M0004A	830 / 607	300 / 32 MC Headwats Replacement	183,039.35	1,262,291.24	293,225.88	1,545,517.12	1,633,225.88	(67,708.76)	16,960.65	(104,669.41)	(87,708.76)	2,598.55		
30M0006A	830 / 607	300 / 32 MC Phase 2 Generator/Transformer	394,292.00	0.00	338,303.52	338,303.52	18,224.65	320,078.90	0.00	0.00	317,480.35	0.00		
30M0006B	832 / 607	300 / 32 Mantel CR Roof	60,135.00	0.00	0.00	0.00	0.00	0.00	0.00	0.00	0.00	0.00		
30M0004A	832	300 WWTp HVAC Replacement	45,000.00	0.00	0.00	0.00	327,000.00	(327,000.00)	0.00	0.00	(327,000.00)	0.00		
30M0006A	832 / 608	320 WWTp CR Chamber Duct Insulation	35,892.00	0.00	0.00	0.00	0.00	0.00	0.00	0.00	0.00	0.00		
30M0006B	832 / 608	320 WWTp Laboratory Renovations	117,150.00	132,837.20	117,944.52	250,161.72	143,000.00	107,161.72	0.00	0.00	107,161.72	0.00		
30M0010A	832 / 608	320 WWTp Roof Replacement	254,780.00	0.00	243,127.73	243,127.73	18,000.00	225,127.73	0.00	0.00	225,127.73	0.00		
30M0010B	832 / 608	320 WWTp Sludge Dryer	100,000.00	0.00	99,392.77	99,392.77	100,000.00	0.00	0.00	0.00	(607.23)	0.00		
30M0016A	832 / 608	320 WWTp Sludge Pump Replacement	529,023.50	27,299.83	483,791.19	511,085.02	290,400.00	511,085.02	27,299.83	483,791.19	511,085.02	0.00		
30M0022A	832 / 608	320 WWTp Generator Replacement	21,131.00	0.00	311,328.00	311,328.00	20,928.00	20,928.00	0.00	0.00	20,928.00	0.00		
30M0024A	832 / 608	320 WWTp Service Water System Upgrade	85,400.00	0.00	0.00	0.00	262,000.00	(262,000.00)	0.00	0.00	(262,000.00)	0.00		
30M0026A	832 / 608	320 WWTp Air Compressor Replacement	41,066.00	0.00	36,646.21	36,646.21	26,161.21	26,161.21	0.00	0.00	26,161.21	0.00		
30M0028A	832 / 608	320 WWTp 2024 Pavement Replacement	418,600.00	0.00	0.00	0.00	10,485.00	0.00	0.00	0.00	0.00	0.00		
30M0024A	832 / 608	320 WWTp Tank Repair Program	50,000.00	0.00	0.00	0.00	0.00	0.00	0.00	0.00	0.00	0.00		
30M0044A	832 / 608	320 WWTp Building Renovation Demolition	300,000.00	0.00	0.00	0.00	0.00	0.00	0.00	0.00	0.00	0.00		
30M0046A	832	320 WWTp UV Lamp Replace	75,000.00	0.00	67,617.96	67,617.96	0.00	67,617.96	0.00	0.00	67,617.96	0.00		
30M0020	834 / 613	320 Sewer Imp-Blissom/Winch	25,841.94	0.00	25,841.94	25,841.94	0.00	25,841.94	0.00	0.00	25,841.94	0.00		
30M0022	834 / 613	320 Sewer Utility Bridges (Winchester over Ash Brook)	45,500.00	0.00	0.00	0.00	0.00	0.00	0.00	0.00	0.00	0.00		
30M0028	834 / 613	320 Sewer Utility Bridges (George over Beaver Brook)	50,000.00	0.00	0.00	0.00	0.00	0.00	0.00	0.00	0.00	0.00		
30M010A	834 / 613	320 State Bypass Utilities (Winchester id to Round)	297,541.00	62,790.00	207,990.90	270,700.90	23,480.00	247,220.90	62,790.00	184,470.90	247,220.90	0.00		
30M020A	834 / 613	320 Sewer Improvements (Holding)	448,617.38	0.00	40,000.00	40,000.00	40,000.00	40,000.00	0.00	0.00	40,000.00	0.00		
30M020D	834	320 Sewer Imp-Inspect Software Dep	275,327.00	580.00	145,206.73	145,786.73	48,690.00	97,096.73	580.00	79,798.13	86,378.13	15,728.60		
30M022Z	834 / 613	320 FY22 Sewer Imp-Force Main Const	689,600.00	0.00	0.00	0.00	0.00	0.00	0.00	0.00	0.00	0.00		
30M022B	834 / 613	320 FY23 Sewer Imp-Force Main Design	867,800.00	0.00	4,105.00	4,105.00	4,105.00	4,105.00	0.00	4,105.00	4,105.00	0.00		
30M022A	834 / 613	320 FY24 Sewer Imp-Island Street	74,607.58	140,392.42	140,392.42	140,392.42	0.00	140,392.42	0.00	140,392.42	0.00	0.00		
30M028B	834 / 613	320 Sewer Improvement - Roxbury Street	203,363.97	0.00	203,363.97	203,363.97	161,798.97	161,798.97	0.00	161,798.97	161,798.97	0.00		
30M022C	834 / 613	320 FY22 Sewer Main Improvements (Downtown)	1,007,110.00	0.00	23,690.74	23,690.74	41,565.00	23,690.74	0.00	23,690.74	23,690.74	0.00		
30M043Z	834 / 613	320 FY23 Sewer Main Lining	200,600.00	0.00	0.00	0.00	0.00	0.00	0.00	0.00	0.00	0.00		
30M043A	834 / 613	320 FY24 Sewer Main Lining	207,600.00	0.00	0.00	0.00	0.00	0.00	0.00	0.00	0.00	0.00		
30M043Z	835 / 613	321 FY25 Sewer Main Lining	32,57	0.00	32,57	32,57	0.00	32,57	0.00	32,57	32,57	0.00		
30M0623	834 / 613	320 FY23 Sewer Manhole Lining	487,697.43	0.00	0.00	0.00	0.00	0.00	0.00	0.00	0.00	0.00		
30M0625	834 / 613	320 FY25 Sewer Manhole Lining	487,697.43	0.00	0.00	0.00	0.00	0.00	0.00	0.00	0.00	0.00		
34M0002A	840 / 609	340 / 34 WTF Filter Media & Underdrain	564,040.13	188,047.87	86,473.77	274,521.64	12,994.30	261,527.34	181,047.87	80,479.47	261,527.34	0.00		
34M0006A	840 / 609	340 / 34 WTF Radc RLC Upgrade	2,922.48	28,829.98	0.00	0.00	34,007.50	34,007.50	0.00	0.00	(5,177.52)	0.00		
34M0008A	840 / 609	340 / 34 WTF 2023 Pavement Replacement	77,992.00	8,011.38	57,798.51	57,798.51	57,798.51	57,798.51	0.00	57,798.51	57,798.51	0.00		
34M0002A	840 / 609	340 / 34 WTF Instrument Replacement/UPS	88,592.16	0.00	52,794.12	52,794.12	0.00	52,794.12	0.00	44,772.74	52,794.12	0.00		
34M002A	842 / 614	340 / 34 1.5 MG Storage Tank Repairs	539,994.56	32,822.56	565,915.46	602,138.02	89,704.88	512,433.14	32,822.56	473,613.58	512,433.14	0.00		
34M004A	842 / 614</													

MUNIS Project #	Munis / Penta CR Fund #	Fund	Project Name	Cap Reserve Budget	PENTA FY22 Penta Pd 13		MUNIS		TOTAL		Revenue		NET		PENTA		MUNIS		TOTAL		REQUEST		
					Expenses	Expenditures	Expenses	Expenditures	Other Sources	Exp Less Other Rev	Revenue	Other Sources	Revenue	Prior Mos Reimb Revenue	Revenue	Prior Mos Reimb Revenue	Revenue	Other Sources	Exp Less Other Rev	Revenue	Prior Mos Reimb Revenue	Revenue	Expenses
34M0222	842 / 614	340 / 34	FY22 Water Dist Imp-Downtown	416,946.00	560.00	228,207.43	228,207.43	640.45	228,267.43	228,267.43	228,267.43	640.45	640.45	640.45	0.00	0.00	0.00	0.00	640.45	640.45	0.00	0.00	Water Infrastructure Capital reserve
34M0225	842	340 / 34	FY24 Water Dist Imp-Island Street	1,080,026.00	0.00	3,395.00	3,395.00	3,395.00	3,395.00	3,395.00	3,395.00	3,395.00	3,395.00	3,395.00	0.00	0.00	0.00	3,395.00	3,395.00	0.00	0.00	Water Infrastructure Capital reserve	
34M0423	842	340 / 34	FY23 Water Main Clean Street	81,300.00	0.00	6,800.00	6,800.00	0.00	6,800.00	6,800.00	6,800.00	0.00	0.00	0.00	0.00	0.00	0.00	0.00	6,800.00	6,800.00	0.00	0.00	Water Infrastructure Capital reserve
34M0523	842	340 / 34	FY23 Water Valve Replacement	102,000.00	0.00	172,268.87	172,268.87	74,269.87	172,268.87	172,268.87	172,268.87	74,269.87	74,269.87	74,269.87	0.00	0.00	0.00	0.00	74,269.87	74,269.87	0.00	0.00	Water Infrastructure Capital reserve
34M0624	842	340 / 34	FY24 Water Valve Replacement	0.00	0.00	0.00	0.00	0.00	0.00	0.00	0.00	0.00	0.00	0.00	0.00	0.00	0.00	0.00	0.00	0.00	0.00	0.00	Water Infrastructure Capital reserve
34M0625	842	340 / 34	FY23 Water Valve Replacement	215,000.00	0.00	107,190.90	107,190.90	107,190.90	107,190.90	107,190.90	107,190.90	107,190.90	107,190.90	107,190.90	0.00	0.00	0.00	0.00	107,190.90	107,190.90	0.00	0.00	Water Infrastructure Capital reserve
22M06AA	850 / 615	300 / 26	City Hall Parking Deck	142,400.00	0.00	70,700.00	70,700.00	50,700.00	70,700.00	70,700.00	70,700.00	50,700.00	50,700.00	50,700.00	0.00	0.00	0.00	0.00	50,700.00	50,700.00	0.00	0.00	City Hall Parking Deck Reserve
22M04BB	852 / 616	300 / 26	Wells Street Structure Maint	207,291.77	3,608.23	473,867.45	473,867.45	45,504.32	473,867.45	473,867.45	473,867.45	45,504.32	45,504.32	45,504.32	3,608.23	3,608.23	0.00	0.00	45,504.32	45,504.32	0.00	0.00	Wells St Parking Garage
21M0002B	860 / 612	410 / 41	Fleet Equipment Replacement	2,746,659.90	0.00	1,759,495.13	1,759,495.13	22,996.00	1,759,495.13	1,759,495.13	1,759,495.13	1,797,160.13	1,797,160.13	1,797,160.13	0.00	0.00	0.00	0.00	1,797,160.13	1,797,160.13	0.00	0.00	Equipment Fund Capital Reserve
21J0002D	872	300 / 26	Transfer Station Interior	175,000.00	0.00	227,103.06	227,103.06	170,297.81	227,103.06	227,103.06	227,103.06	170,297.81	170,297.81	170,297.81	0.00	0.00	0.00	0.00	170,297.81	170,297.81	0.00	0.00	Transfer/Recycling - Solid Waste Facility
21J0004A	872	300	Pavement Replacement Project	297,500.00	0.00	0.00	0.00	56,805.25	0.00	0.00	0.00	0.00	0.00	0.00	0.00	0.00	0.00	0.00	0.00	0.00	0.00	0.00	Transfer/Recycling - Solid Waste Facility
21M0002A	872 / 610	300 / 26	Recycling Equipment Replacement	200,000.00	0.00	0.00	0.00	0.00	0.00	0.00	0.00	0.00	0.00	0.00	0.00	0.00	0.00	0.00	0.00	0.00	0.00	0.00	Transfer/Recycling - Solid Waste Facility

84,092.46 Thu December 26, Cap Reserve WD

CITY OF KEENE, NH
 REPORT OF THE TRUSTEES OF TRUST FUNDS
 COMMON TRUST FUND (ACCOUNT NUMBER XXX4482)
 FOR YEAR ENDING: 06/30/2025
 AS OF: 12/31/2024

FUND #	FUND NAME	PURPOSE	PRINCIPAL										INCOME				TOTAL MARKET VALUE PRINCIPAL & INCOME			
			PRINCIPAL BEGIN MARKET VALUE	PRINCIPAL COST BALANCE	PRINCIPAL NEW FUNDS	PRINCIPAL UNREALIZED GAINS/LOSSES	PRINCIPAL REALIZED GAINS/LOSSES	CAPITAL GAINS DIVIDENDS *	PRINCIPAL FEES	PRINCIPAL WITHDRAWALS	PRINCIPAL ENDING MARKET VALUE	INCOME BEGIN BALANCE	INCOME	INCOME FEES	INCOME EXPENDED	INCOME ENDING BALANCE		TOTAL COST PRINCIPAL & INCOME		
928	Abbott A. Lane Park Fund	Park/Recreation	97,029.06	70,041.38	0.00	(2,860.48)	432.74	173.61	0.00	0.00	0.00	70,847.63	94,230.08	2,811.86	351.10	(52.13)	0.00	3,110.83	73,756.56	97,347.02
930	Abbott A. Lane Playground Fund	Park/Recreation	18,847.37	13,001.63	0.00	(979.22)	84.09	33.70	0.00	0.00	0.00	18,719.39	18,304.85	546.18	68.18	(10.12)	0.00	694.24	14,323.63	18,000.00
936	Asahel River Park Trust	Park/Recreation	571,655.05	483,975.92	0.00	(17,477.27)	2,540.50	1,022.27	0.00	0.00	0.00	487,547.00	555,200.05	18,074.43	2,422.37	(359.06)	0.00	20,737.14	508,284.23	575,837.19
978	Campo Sialco Trust	Cemetery Perpetual Care	10,133.70	13,098.72	0.00	(483.20)	71.95	28.95	0.00	0.00	0.00	13,098.52	15,890.29	2,001.61	72.77	(10.80)	0.00	2,093.59	16,203.10	17,793.87
928	Candace H. Ingersoll	Park/Recreation	5,930.30	4,301.98	0.00	(181.49)	20.49	10.82	0.00	0.00	0.00	4,302.08	5,765.52	172.22	21.56	(3.20)	0.00	190.58	4,520.86	5,950.10
844	Candice Ingersoll	Library	5,850.27	4,287.07	0.00	(178.88)	26.09	10.46	0.00	0.00	0.00	4,282.82	5,681.87	615.31	23.82	(3.51)	0.00	685.92	4,699.04	6,317.28
964	Carric K. Henry Trust	Library	169,420.19	143,938.47	0.00	(6,969.90)	889.38	388.61	0.00	0.00	0.00	145,158.46	163,679.90	20,980.01	794.64	(17.88)	0.00	21,628.07	160,812.13	215,396.57
968	Cemetery Trust Fund A - Perpetual Care of Cemeteries	Cemetery Perpetual Care	2,330,401.14	1,992,731.57	0.00	(70,330.41)	10,339.44	4,113.74	0.00	0.00	0.00	1,707,110.39	2,324,194.47	66,876.32	1,235.89	(1,259.88)	0.00	73,935.32	1,760,871.08	2,307,693.79
974	Cemetery Trust Fund B - Cemetery Capital Reserve	Maintenance and Repair	1,891,109.73	1,218,310.57	0.00	(48,646.17)	7,096.11	2,846.31	0.00	0.00	0.00	2,256,251.99	1,546,308.97	225,648.94	6,969.67	(1,833.20)	0.00	231,570.34	1,499,822.44	1,778,880.32
914	Charles A. Jones Fund	Park/Recreation	35,490.79	25,330.47	0.00	(1,084.15)	158.15	63.41	0.00	0.00	0.00	25,281.00	34,400.04	19,202.96	213.22	(81.69)	0.00	19,384.51	44,846.54	63,874.55
952	Claire B. Woodard	Library	27,003.33	19,957.57	0.00	(853.08)	124.44	46.90	0.00	0.00	0.00	22,905.91	27,090.00	13,388.73	102.83	(15.24)	0.00	14,286.12	21,588.03	28,526.02
906	Clematis Woodward Fund	Pool/Indigent	1,287,096.33	919,733.21	0.00	(38,757.42)	5,854.74	2,889.95	0.00	0.00	0.00	922,995.91	1,231,208.87	6,488.71	611.97	(3.92)	0.00	224,357.67	1,147,391.58	1,485,963.54
932	Dinosaur Woods Trust	Park/Recreation	7,396.58	6,538.61	0.00	(226.14)	32.99	13.23	0.00	0.00	0.00	6,580.03	7,169.67	214.33	28.73	(3.87)	0.00	237.09	6,812.12	7,420.76
924	Emily A. Elliot Daland	Park/Recreation	8,020.20	5,800.73	0.00	(645.20)	38.77	14.34	0.00	0.00	0.00	5,850.04	7,789.34	232.55	28.09	(4.32)	0.00	257.31	6,108.15	8,046.85
970	Flower Fund	Pool/Indigent	225,277.17	164,159.78	0.00	(6,887.42)	1,004.70	402.85	0.00	0.00	0.00	185,597.33	218,792.00	6,543.40	822.86	(122.14)	0.00	7,243.92	172,811.25	228,038.52
964	Frank Wright Scholarship Fund	Scholarship	1,951,571.63	1,491,437.72	0.00	(59,895.61)	8,700.72	3,489.91	0.00	0.00	0.00	1,443,631.35	1,895,305.63	123,320.83	7,492.70	(1,142.48)	0.00	128,701.04	1,573,332.30	2,025,068.97
922	George A. Whitebeck	Park/Recreation	83,021.51	59,934.93	0.00	(2,539.23)	370.26	148.46	0.00	0.00	0.00	60,462.75	80,631.74	2,408.03	300.43	(44.51)	0.00	2,661.95	63,114.60	83,263.59
946	George S. Ellis	Library	1,970.48	1,421.11	0.00	(60.24)	8.79	3.52	0.00	0.00	0.00	1,433.42	1,913.74	212.83	7.87	(1.17)	0.00	219.63	1,613.05	2,133.37
920	George S. Elliot Fund	Library	748.16	547.62	0.00	(23.88)	9.34	1.34	0.00	0.00	0.00	531,948.83	703,716.50	1,033.57	2,841.89	(82.23)	0.00	28,287.03	55,938.88	728,699.53
966	Greenwood Cemetery	Cemetery Trust (Other)	724,589.12	527,122.63	0.00	(22,152.33)	3,231.47	1,295.71	0.00	0.00	0.00	531,948.83	703,716.50	1,033.57	2,841.89	(82.23)	0.00	28,287.03	55,938.88	728,699.53
972	Ingersoll Collection Trust	Maintenance and Repair	17,241.36	14,906.13	0.00	(32,112)	76.86	30.85	0.00	0.00	0.00	14,919.95	16,749.97	4,941.07	95.17	(14.16)	0.00	5,022.11	16,933.99	21,767.16
940	John E. Colony Cemetery Fund	Cemetery Perpetual Care	94,300.68	27,193.09	0.00	(1,048.69)	152.88	61.34	0.00	0.00	0.00	27,347.41	33,313.34	13,978.95	198.13	(26.42)	0.00	14,107.68	47,406.07	62,513.15
956	John T. Foster Library Trust	Library	31,722.47	19,912.00	0.00	(996.85)	141.48	59.73	0.00	0.00	0.00	14,010.21	30,809.35	1,974.19	76.07	(11.30)	0.00	2,038.96	16,046.17	32,846.31
934	Keene Downtown Memorial Tree Fund	Library	24,516.18	16,984.16	0.00	(740.54)	106.34	43.84	0.00	0.00	0.00	16,117.34	23,810.48	1,607.88	99.14	(14.72)	0.00	1,692.26	20,609.62	25,502.78
982	Keene Downtown Memorial Tree Fund	Bauitification	481,152.77	374,687.88	0.00	(14,710.34)	2,145.87	980.42	0.00	0.00	0.00	377,884.27	487,302.85	14,185.04	1,874.11	(278.20)	0.00	15,790.59	363,485.16	483,003.74
915	Maria Griffin Fund	Maintenance and Repair	249,380.18	191,440.60	0.00	(7,932.75)	1,107.74	444.17	0.00	0.00	0.00	192,892.51	241,230.60	13,618.88	987.74	(148.89)	0.00	14,390.06	207,362.57	255,580.06
950	Maria W. Osborne Library Fund	Library	7,209.92	5,209.20	0.00	(220.42)	32.15	12.89	0.00	0.00	0.00	5,254.33	7,002.09	1,691.31	33.25	(4.84)	0.00	1,719.62	6,973.85	8,721.71
904	Mary P. Lane Trust Fund	Library	972.82	705.08	0.00	(20.74)	4.34	1.74	0.00	0.00	0.00	711.16	944.82	159.86	4.17	(0.82)	0.00	163.41	874.57	1,108.23
946	Mary R. Hall Charitable Fund	Pool/Indigent	116,007.69	83,788.50	0.00	(3,540.17)	517.73	207.59	0.00	0.00	0.00	84,519.82	112,749.28	3,364.23	420.00	(82.30)	0.00	3,721.67	88,235.66	116,466.15
946	Mary R. Hall Charitable Fund	Pool/Indigent	35,822.71	25,898.22	0.00	(1,095.21)	159.76	84.05	0.00	0.00	0.00	28,110.04	34,791.59	1,038.42	129.76	(19.27)	0.00	1,148.91	27,259.95	35,940.47
960	Munroe Alger Scholarship Fund	Library	3,925.76	2,131.12	0.00	(60.37)	13.16	5.29	0.00	0.00	0.00	2,148.59	2,870.98	318.37	11.76	(1.75)	0.00	323.40	2,472.90	3,194.08
912	Munroe Alger Scholarship Fund	Scholarship	350,305.09	254,022.31	0.00	(10,711.77)	1,852.58	625.54	0.00	0.00	0.00	255,811.43	340,280.48	5,955.35	1,255.79	(188.45)	0.00	7,024.88	268,988.11	347,308.14
966	Miscellaneous Cemeteries	Cemetery Trust (Other)	14,936.45	10,679.83	0.00	(440.06)	65.37	26.21	0.00	0.00	0.00	10,671.11	14,284.57	424.73	33.03	(7.87)	0.00	469.99	11,141.00	14,704.46
908	Police Benevolent Fund	Cemetery Trust (Other)	49,958.34	33,192.53	0.00	(1,438.60)	208.42	83.97	0.00	0.00	0.00	33,485.92	46,004.71	1,354.07	106.49	(24.72)	0.00	1,485.94	34,981.76	39,551.22
910	Police Benevolent Fund	Police/Fire	326,984.28	221,383.52	0.00	(10,998.07)	1,497.22	588.31	0.00	0.00	0.00	223,439.06	319,614.62	77,809.61	1,441.87	(214.03)	0.00	79,039.70	302,575.75	396,551.22
918	Renard Firefighters Relief Fund	Police/Fire	182,841.36	118,810.90	0.00	(5,683.91)	814.65	329.61	0.00	0.00	0.00	117,652.06	177,394.06	131,309.44	1,057.74	(177.54)	0.00	132,326.84	250,278.70	300,170.70
900	Seneca W. Upton Fund	Pool/Indigent	44,122.35	33,410.88	0.00	(1,348.99)	198.78	78.00	0.00	0.00	0.00	33,666.54	42,852.28	7,761.44	198.41	(26.46)	0.00	7,918.33	41,616.83	50,792.88
900	Seneca W. Upton Fund	Pool/Indigent	29,791.52	17,153.55	0.00	(729.47)	105.87	42.49	0.00	0.00	0.00	17,302.01	23,077.54	688.62	85.88	(12.77)	0.00	781.83	18,093.84	23,838.37
942	Summer Knight Chapel	Maintenance and Repair	39,454.06	20,052.09	0.00	(1,115.45)	192.72	65.24	0.00	0.00	0.00	20,886.05	35,434.45	1,974.68	137.94	(20.48)	0.00	2,092.18	28,872.21	37,528.61
904	Thayer and Chapin Fund	Library	97,298.17	70,177.59	0.00	(2,872.81)	433.98	173.88	0.00	0.00	0.00	70,785.13	94,437.24	10,215.06	387.43	(57.52)	0.00	10,544.87	81,330.10	104,962.21
962	Washington Street Cemetery	Cemetery Trust (Other)	13,795.41	9,953.18	0.00	(421.77)	61.53	24.87	0.00	0.00	0.00	10,039.36	13,306.31	369.75	48.89	(7.41)	0.00	442.23	10,481.81	13,840.54
972	West Keene Cemetery	Cemetery Trust (Other)	74,690.67	53,981.15	0.00	(2,288.89)	333.80	133.78	0.00	0.00	0.00	54,458.51	72,647.54	2,187.70	270.64	(40.18)	0.00	2,398.16	56,859.87	75,045.70
976	Woodland Cemetery	Cemetery Trust (Other)	1,159,478.80	830,844.53	0.00	(35,415.24)	5,168.64	2,071.65	0.00	0.00	0.00	633,080.82	1,125,134.31	33,521.51	4,165.55	(618.48)	0.00	37,088.58	875,649.40	1,162,198.89
933	Woodland Extension	Cemetery Trust (Other)	850,732.41	613,403.36	0.00	(20,006.33)	3,794.14	1,321.33	0.00	0.00	0.00	618,716.85	826,244.21	24,548.02	3,074.60	(458.55)	0.00	27,288.37	645,865.22	853,510.38
TOTAL			13,383,194.54	9,850,864.31	0.00	(408,860.51)	88,588.76	23,897.16	0.00	0.00	0.00	9,834,980.23	12,875,731.19	1,087,349.						

CITY OF KEENE, NH
 REPORT OF THE TRUSTEES OF TRUST FUNDS
 CAPITAL RESERVE (ACCOUNT NUMBER XXX4474)
 FOR YEAR ENDING: 06/30/2025
 AS OF: 12/31/2024

FUND NAME	FUN D #	PURPOSE	DATE OF CREATION	PRINCIPAL										INCOME			TOTAL MARKET VALUE PRINCIPAL & INCOME	
				COST OPENING BALANCE	PRINCIPAL NEW FUNDS	PRINCIPAL REALIZED GAINS	CAPITAL GAINS DIVIDENDS	PRINCIPAL FEES	PRINCIPAL WITHDRAWALS	PRINCIPAL ENDING COST BALANCE	PRINCIPAL ENDING FAIR VALUE	INCOME BEGIN BALANCE	INCOME	INCOME FEES	INCOME EXPENDED	INCOME ENDING BALANCE		TOTAL COST PRINCIPAL & INCOME
Ambulance Capital Reserve	800	Police/Fire	1/1/1988	137,853.14	0.00	0.00	0.03	0.00	0.00	0.00	186,362.33	186,264.24	726.16	0.00	0.00	0.00	186,362.33	186,264.24
Bridge Capital Reserve	809	Maintenance and Repair	1/1/2002	1,823,529.20	0.00	0.00	0.24	0.00	(53,983.16)	0.00	1,776,061.28	1,757,387.13	6,527.98	0.00	0.00	0.00	1,776,061.28	1,757,387.13
City Hall Parking Deck Capital Reserve	850	Maintenance and Repair	1/1/1989	255,894.26	0.00	0.00	0.03	0.00	0.00	0.00	256,908.57	254,204.45	944.26	0.00	0.00	0.00	256,908.57	254,204.45
Downtown Infrastructure and Facility Capital Reserve	810	Economic Development	1/1/2008	2,015,410.32	0.00	0.00	0.24	0.00	(161,550.16)	0.00	1,849,625.69	1,821,251.96	8,765.29	0.00	0.00	0.00	1,849,625.69	1,821,251.96
Emergency Communication Capital Reserve	816	Capital Reserve (Other)	5/7/2020	5,432.71	0.00	0.00	0.00	0.00	0.00	0.00	5,452.75	5,385.36	20.04	0.00	0.00	0.00	5,452.75	5,385.36
Fire Equipment Capital Reserve	802	Police/Fire	1/1/1988	723,994.80	0.00	0.00	0.10	0.00	0.00	0.00	726,665.79	718,017.19	2,870.89	0.00	0.00	0.00	726,665.79	718,017.19
Fleet Equipment Capital Reserve	860	Maintenance and Repair	1/1/1988	322,325.50	0.00	0.00	0.04	0.00	(50,055.08)	0.00	273,278.81	270,402.48	1,004.45	0.00	0.00	0.00	273,278.81	270,402.48
Hazardous Waste Site Capital Reserve	870	Environmental Purposes	1/1/1988	54,532.27	0.00	0.00	0.01	0.00	0.00	0.00	54,733.45	54,157.35	204.17	0.00	0.00	0.00	54,733.45	54,157.35
Information Technology Systems and Infrastructure Capital Reserve	820	Capital Reserve (Other)	5/7/2020	160,325.01	0.00	0.00	0.02	0.00	(7,809.45)	0.00	153,073.21	151,462.02	562.63	0.00	0.00	0.00	153,073.21	151,462.02
Intersection Improvements Capital Reserve	804	Economic Development	1/1/1988	2,146.27	0.00	0.00	0.00	0.00	0.00	0.00	2,154.19	2,131.52	7.92	0.00	0.00	0.00	2,154.19	2,131.52
Landfill Closure Capital Reserve	974	Environmental Purposes	1/1/1980	23,799.17	0.00	0.00	0.00	0.00	0.00	0.00	23,886.87	23,635.55	87.90	0.00	0.00	0.00	23,886.87	23,635.55
Marble Court Pumping Station Capital Reserve	830	Maintenance and Repair	1/1/1982	287,352.77	0.00	0.00	0.04	0.00	0.00	0.00	288,412.88	285,377.16	1,060.07	0.00	0.00	0.00	288,412.88	285,377.16
Parks and Facilities Infrastructure Fund	822	Parks/Recreation	5/19/2022	916,748.47	0.00	0.00	0.11	0.00	(94,900.80)	0.00	826,857.23	818,183.74	3,039.25	0.00	0.00	0.00	826,857.23	818,183.74
Reappraisal Capital Reserve	818	Capital Reserve (Other)	5/7/2020	124,661.03	0.00	0.00	0.02	0.00	0.00	0.00	125,321.87	124,002.58	460.67	0.00	0.00	0.00	125,321.87	124,002.58
Road and Sidewalk Infrastructure Capital Reserve	814	Maintenance and Repair	5/7/2020	726,418.07	0.00	0.00	0.09	0.00	(17,143.86)	0.00	711,860.78	704,387.70	2,616.58	0.00	0.00	0.00	711,860.78	704,387.70
Sewer Infrastructure Capital Reserve	834	Maintenance and Repair	1/1/1988	4,344,604.95	0.00	0.00	0.55	0.00	(7,077.53)	0.00	4,353,528.54	4,307,705.97	16,001.54	0.00	0.00	0.00	4,353,528.54	4,307,705.97
Tire and Recycling Center Capital Reserve	872	Maintenance and Repair	1/1/1988	391,248.78	0.00	0.00	0.05	0.00	0.00	0.00	392,693.17	388,559.84	1,443.36	0.00	0.00	0.00	392,693.17	388,559.84
Transportation Improvements Capital Reserve	812	Maintenance and Repair	1/1/2015	377,081.61	0.00	0.00	0.05	0.00	(49.64)	0.00	378,422.83	374,438.80	1,350.81	0.00	0.00	0.00	378,422.83	374,438.80
Wastewater Treatment Plant Capital Reserve	832	Maintenance and Repair	1/1/1992	1,005,117.13	0.00	0.00	0.24	0.00	(87,817.96)	0.00	1,844,278.12	1,824,865.97	6,778.71	0.00	0.00	0.00	1,844,278.12	1,824,865.97
Water Infrastructure Capital Reserve	842	Maintenance and Repair	1/1/1988	2,482,914.03	0.00	0.00	0.31	0.00	(127,769.84)	0.00	2,903,833.45	2,338,852.66	8,668.35	0.00	0.00	0.00	2,903,833.45	2,338,852.66
Water Treatment Facility Capital Reserve	840	Maintenance and Repair	1/1/1983	847,698.39	0.00	0.00	0.08	0.00	(20,989.68)	0.00	823,941.87	823,311.35	2,315.37	0.00	0.00	0.00	823,941.87	823,311.35
Wells Street Parking Facility Capital Reserve	852	Maintenance and Repair	1/1/1988	384,031.06	0.00	0.00	0.05	0.00	0.00	0.00	383,374.06	381,328.28	1,342.85	0.00	0.00	0.00	383,374.06	381,328.28
TOTALS				18,155,184.43	0.00	0.00	2.33	0.00	(828,037.26)	0.00	17,591,868.82	17,408,644.32	64,659.32	0.00	0.00	0.00	17,591,868.82	17,408,644.32

Sherry Miller

From: Somma, Virginia <vsomma@sau29.org>
Sent: Wednesday, November 20, 2024 11:45 AM
Subject: KHS Scholarships, 2025

Good afternoon!

I hope this email finds you happy and healthy as we head into the Thanksgiving holiday. The students and staff are looking forward to a few days' break next week - we're nearly through one third of the school year already and we've all been working hard!



While graduation may feel far away, in the back offices we are already busily planning end-of-year events.

The start of scholarship season begins in earnest in February, so I wanted to reach out now with a timeline for you. If you already know that your group will not be offering a 2025 scholarship, or if contact information for the scholarship program has changed, please let me know now and I'll take you off the email list.

Thank you for all you do for the students.

June 2025 Scholarship Timeline

December / January: Please confirm for me that your group is offering a scholarship in 2025, and let me know if scholarship contact information has changed.

February 24: Students are on break this week. I would love to have updated scholarship applications and any pertinent information during this week so that I can prepare photocopies and finalize things on my end.

March 14: Scholarship applications are made available to students. I display them in the Main Lobby for a full month.

April 14: Scholarship applications due from students. I have a collection box in the Main Office.

April 18 - 24: Packets of applications that are being collected by KHS and picked up by donors can be picked up during this time frame.

May 9 - 14: Recipient / winner names due to me if your group is selecting. Also at this time, please tell me who will be presenting at the awards night so I can prepare the program. If the KHS scholarship committee is selecting the winner for your group, I will let you know the recipient information during this time.

May 21-23: Counselors invite recipients to scholarship night. The school counselors let them know they've won *something* and should attend the evening, but they don't tell them which scholarship they've won or how much.

June 4: Scholarship night. KHS Auditorium, 6pm.

All the Best,
Ginny

--

Virginia Somma
Assistant, Principal's Office
Keene High School
603.352.0640 ext. 3764
khs.keeneschoolsnh.org

Environmental awareness message

Please do not print this email unless you have to

CONFIDENTIALITY NOTICE:

This message is intended only for the designated recipient(s). It may contain confidential or proprietary information and may be subject to the attorney-client privilege or other confidentiality protections. If the reader of this message is not the intended recipient, or an authorized employee or agent of the intended recipient, you are hereby notified that any dissemination, distribution or copying of this communication is strictly prohibited and may subject you to civil action and/or criminal prosecution. If you have received this communication in error, please notify us by replying to this message and deleting it from your computer and any network to which your computer is connected. Thank you.