

# KEENE INFRASTRUCTURE IMPROVEMENTS **PHASE 2 PRELIMINARY DESIGN** **GILBO AVE/RAILROAD SQUARE**

MSFI COMMITTEE MEETING

APRIL 24, 2024

Seat Wall

Bike Lane

Bike Rack

Public Art

Outdoor Café

# KEENE PHASE 2 | GILBO AVE/RAILROAD SQUARE

## DESIGN REVIEW WORKSHOP #2

### DESIGN REVIEW WORKSHOPS

MARCH

**06** WED  
3-4:30PM & 5:30-7PM

DESIGN AREA 1: **Main St. Streetscape**

APRIL

**10** WED  
3-4:30PM & 5:30-7PM

DESIGN AREA 2: **Gilbo Ave./Railroad Sq.**

MAY

**01** WED  
3-4:30PM & 5:30-7PM

DESIGN AREA 3: **Central Square**

**AT** Keene Recreation Center  
312 Washington St., Room 14

### MSFI COMMITTEE MEETINGS

MARCH

**13** WED  
5:30PM

DESIGN AREA 1: **Main St. Streetscape**

APRIL

**24** WED  
5:30PM

DESIGN AREA 2: **Gilbo Ave./Railroad Sq.**

MAY

**08** WED  
5:30PM

DESIGN AREA 3: **Central Square**

**AT** City Hall, Council Chambers  
scan live-streaming QR code:



### Workshop Stations

- Gilbo Avenue Design
- Railroad Square Design
- Sustainable Streetscape Design



Outdoor Café

# KEENE PHASE 2 | MAIN ST STREETSCAPE SITE RENDERING PLAN - OVERALL

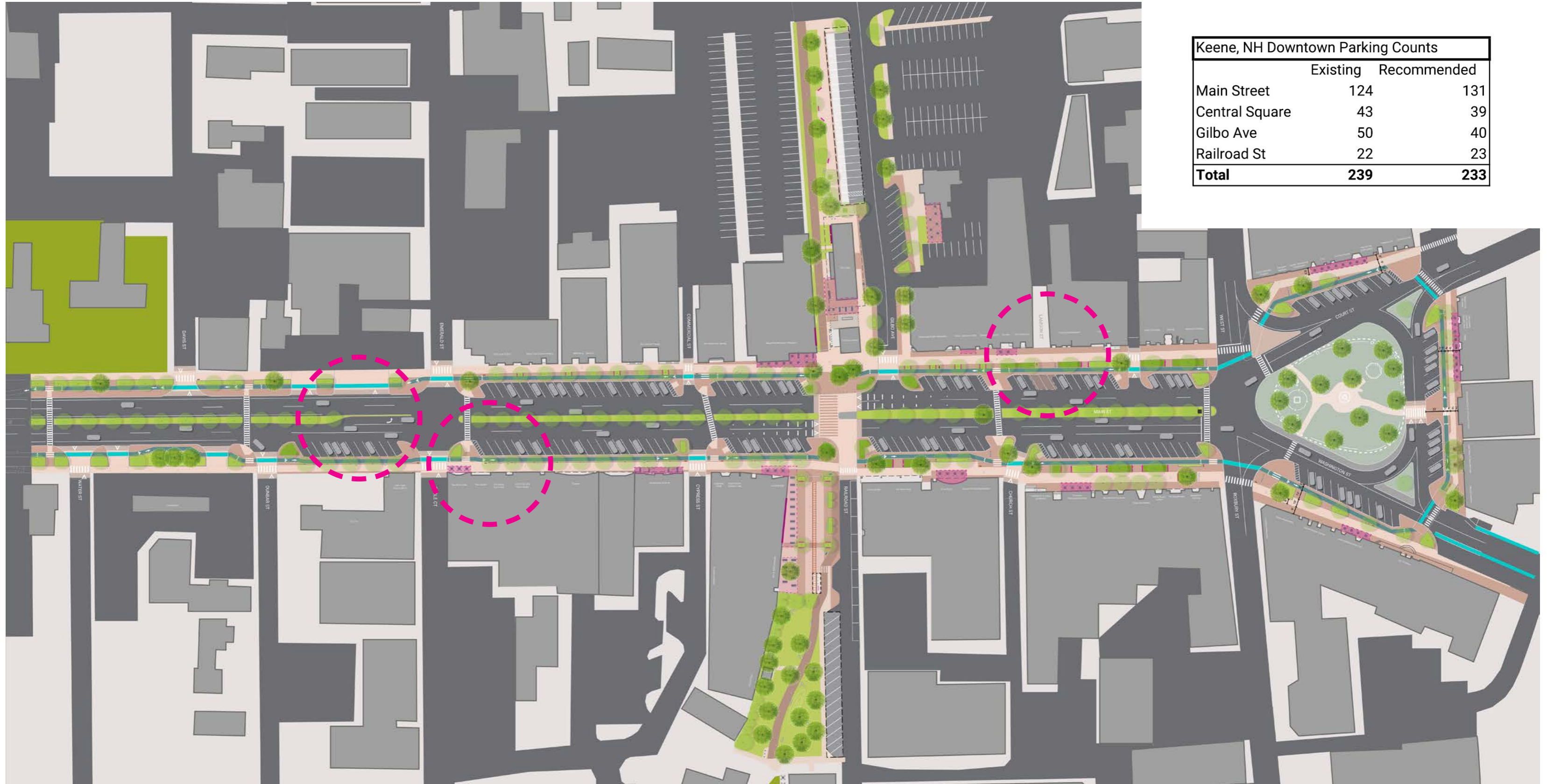

Keene, NH Downtown Parking Counts		
	Existing	Recommended
Main Street	124	131
Central Square	43	39
Gilbo Ave	50	40
Railroad St	22	23
<b>Total</b>	<b>239</b>	<b>233</b>

# KEENE PHASE 2 | MAIN ST STREETSCAPE

## LEFT-TURN POCKET AT EMERALD ST

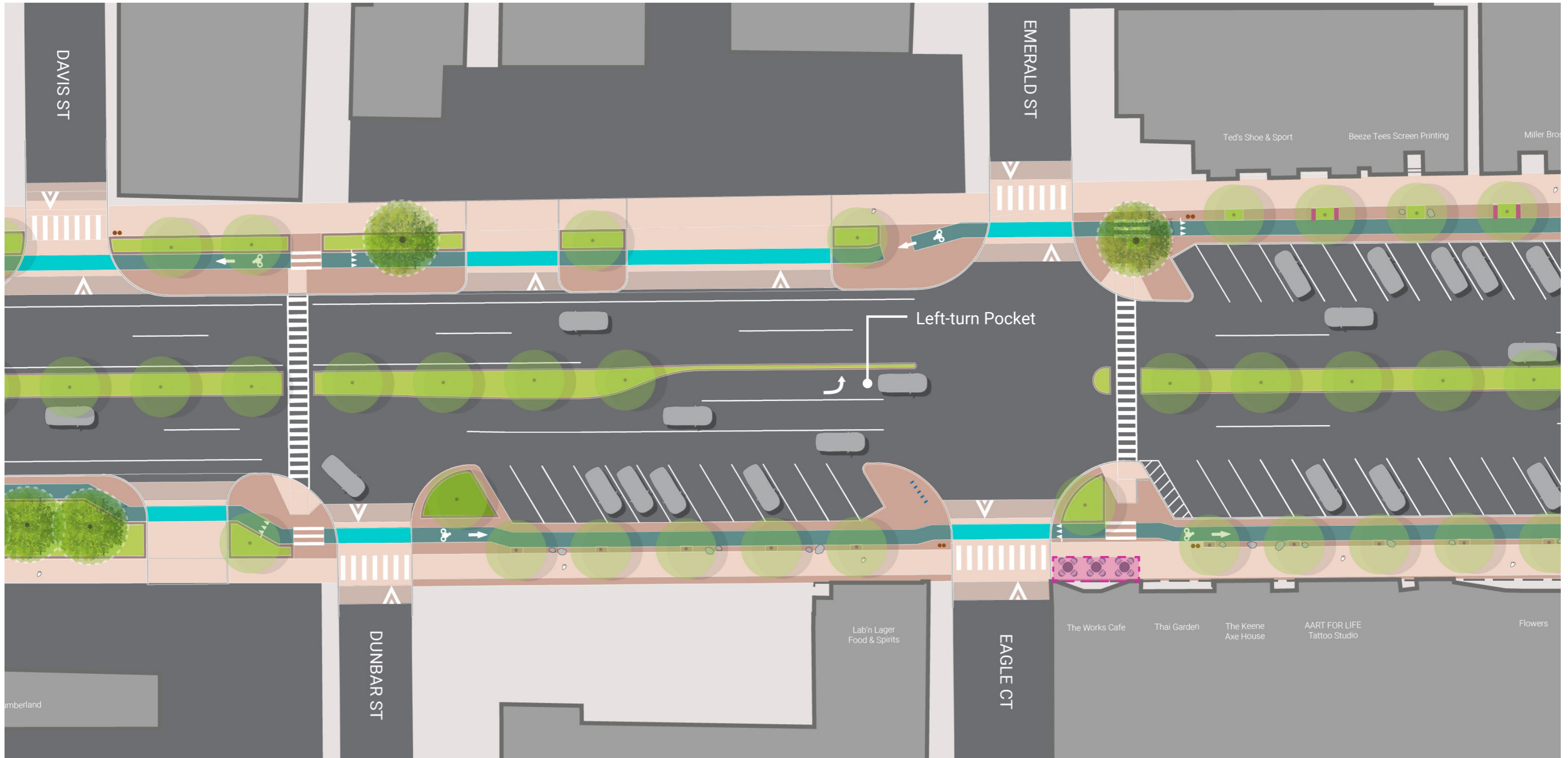

KEENE PHASE 2 | MAIN ST STREETSCAPE  
**THE WORKS COMMERCE ZONE**

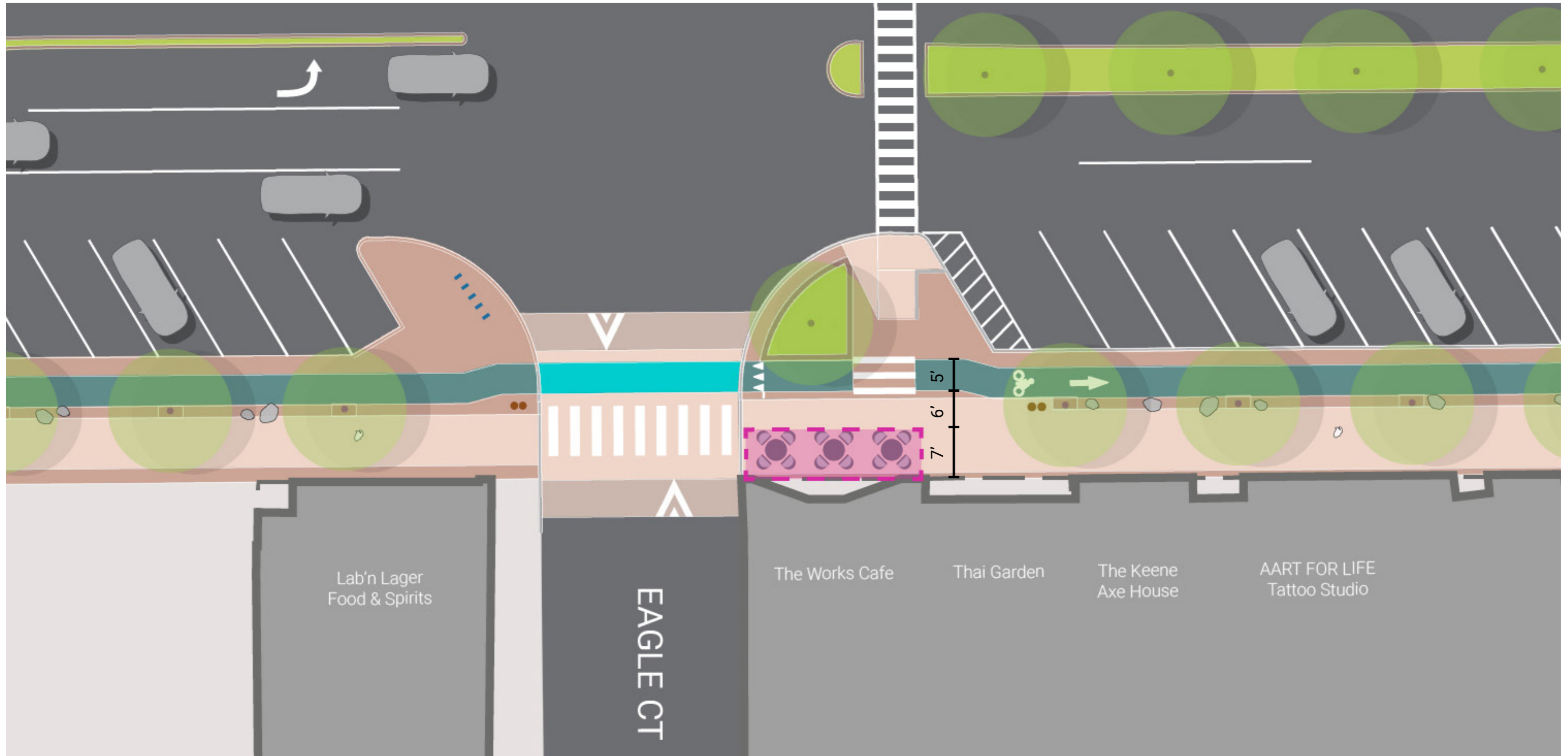

# KEENE PHASE 2 | MAIN ST STREETSCAPE LAMSON ST CLOSURE

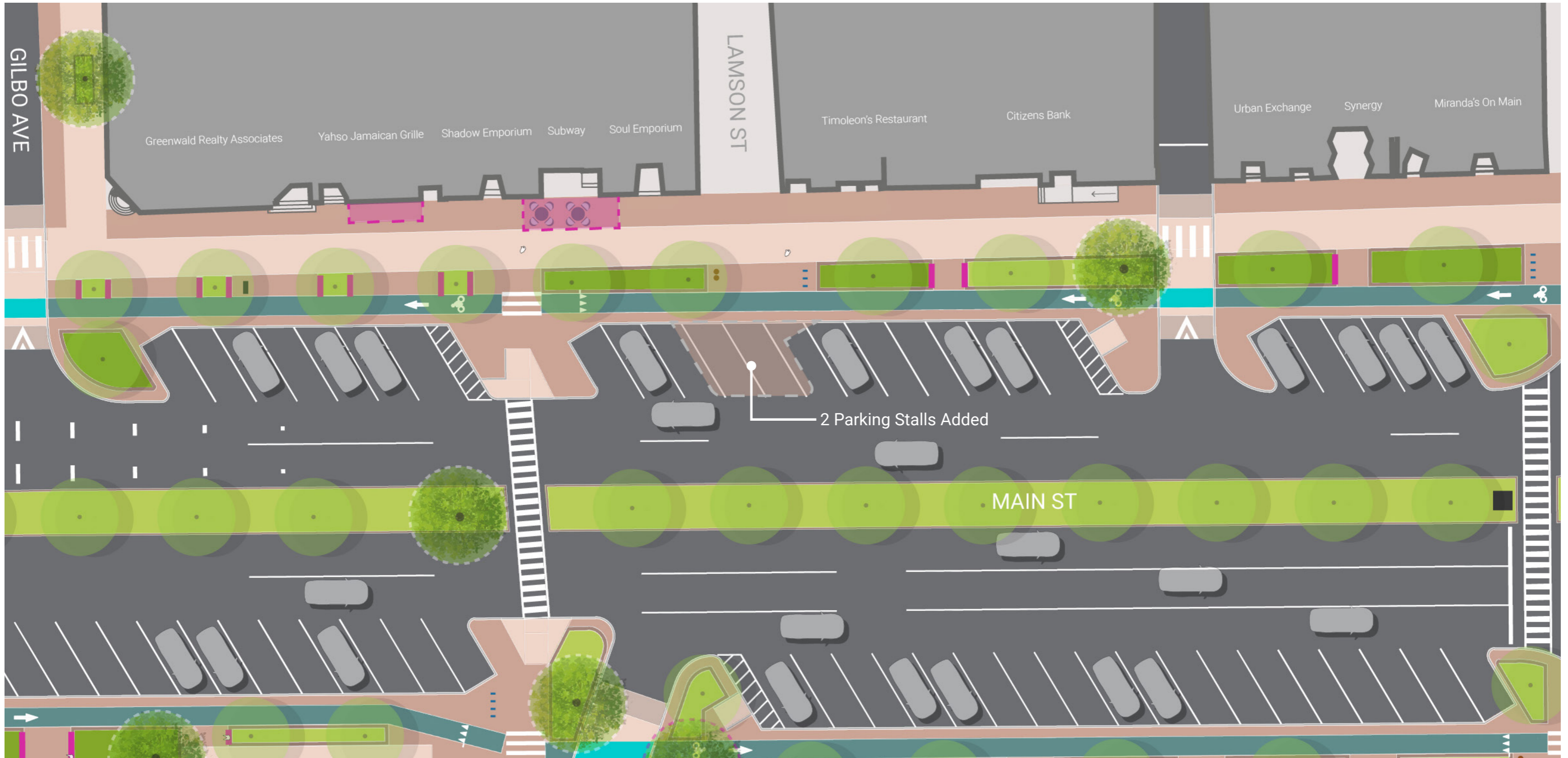

# KEENE PHASE 2 | MAIN ST STREETSCAPE

## TRAFFIC VOLUME

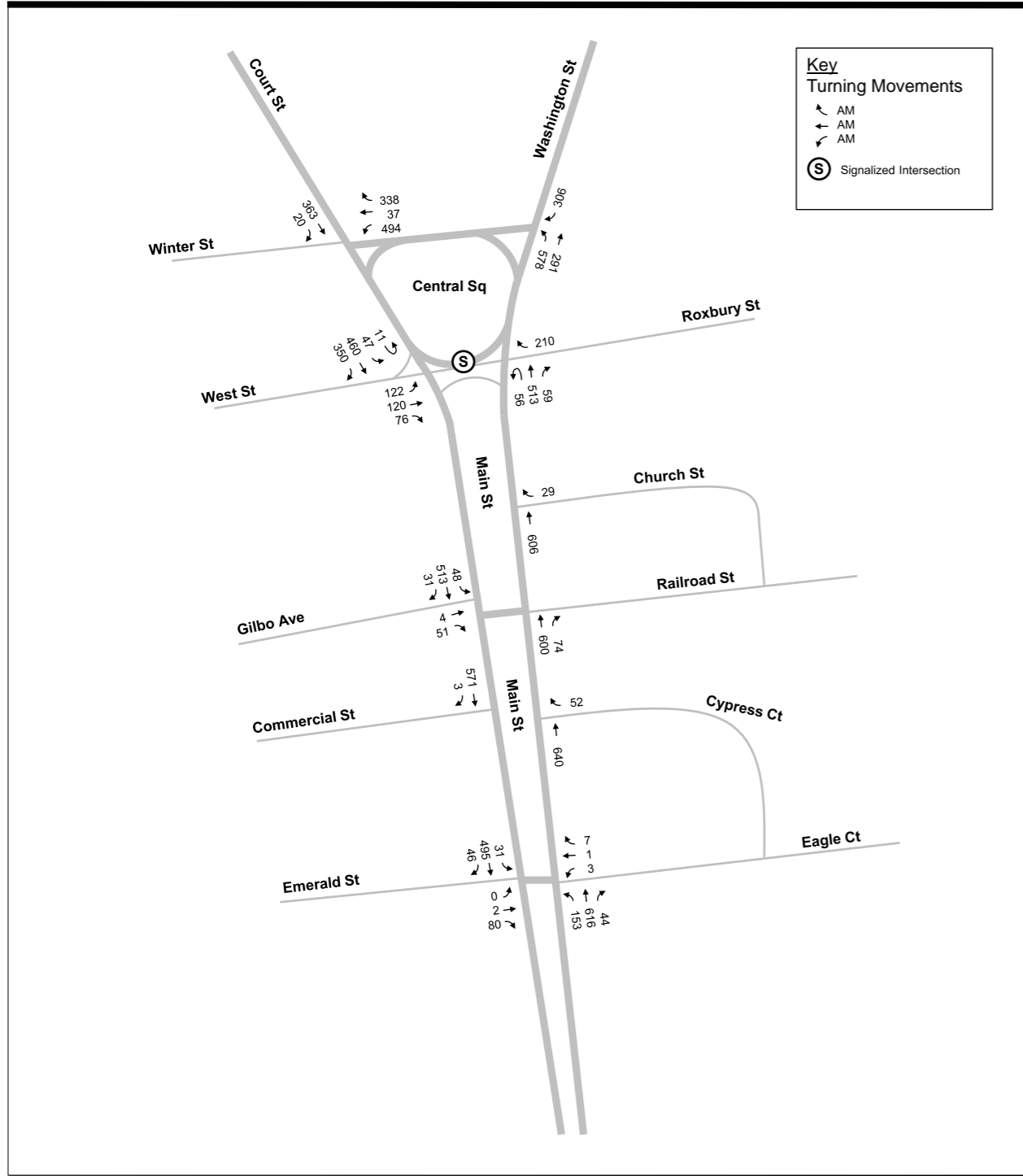

Figure 1 Schematic Diagram:  
2022 Existing AM Peak Hour Traffic Volumes

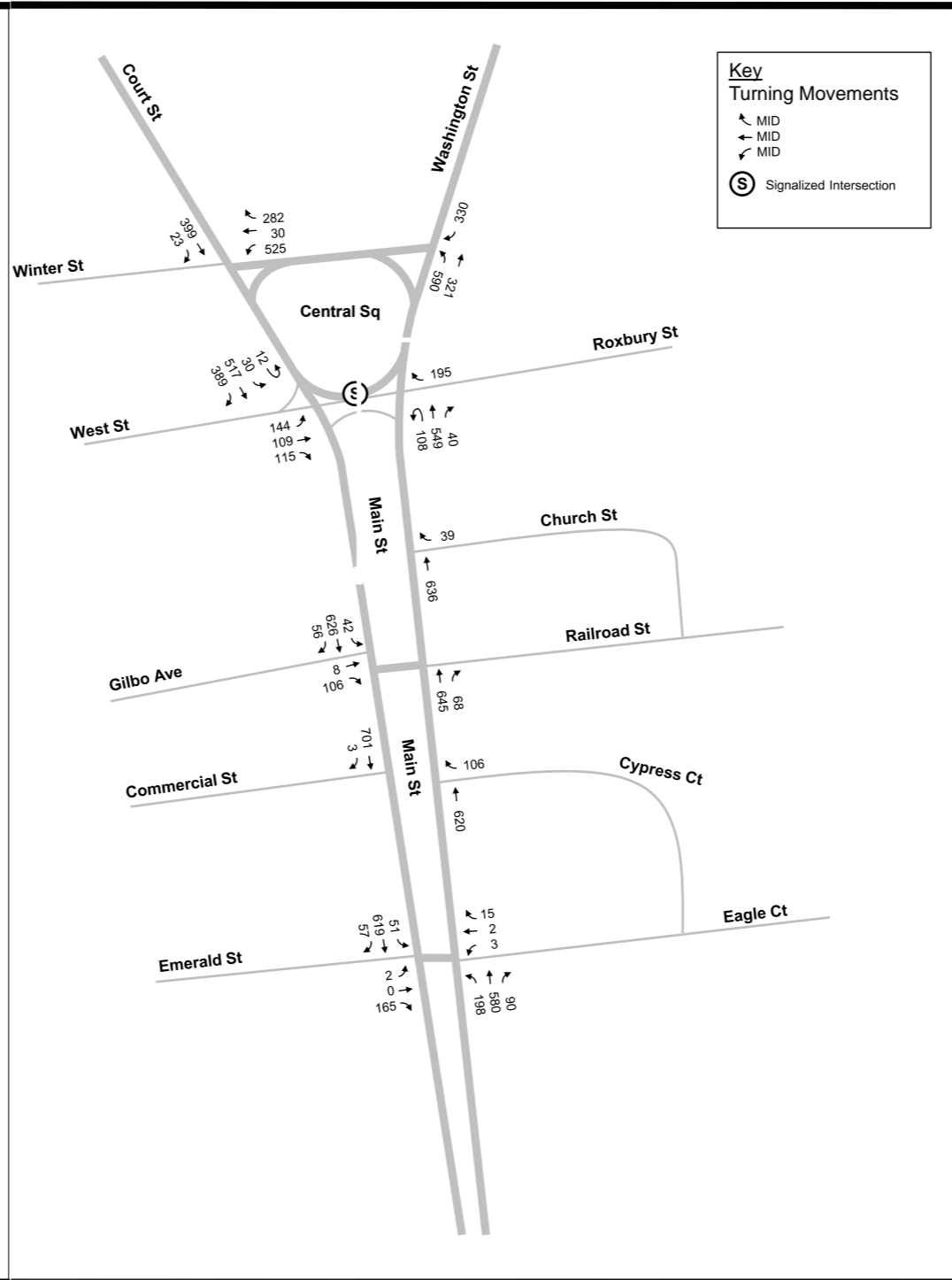

Figure 3 Schematic Diagram:  
2022 Existing MID Peak Hour Traffic Volumes

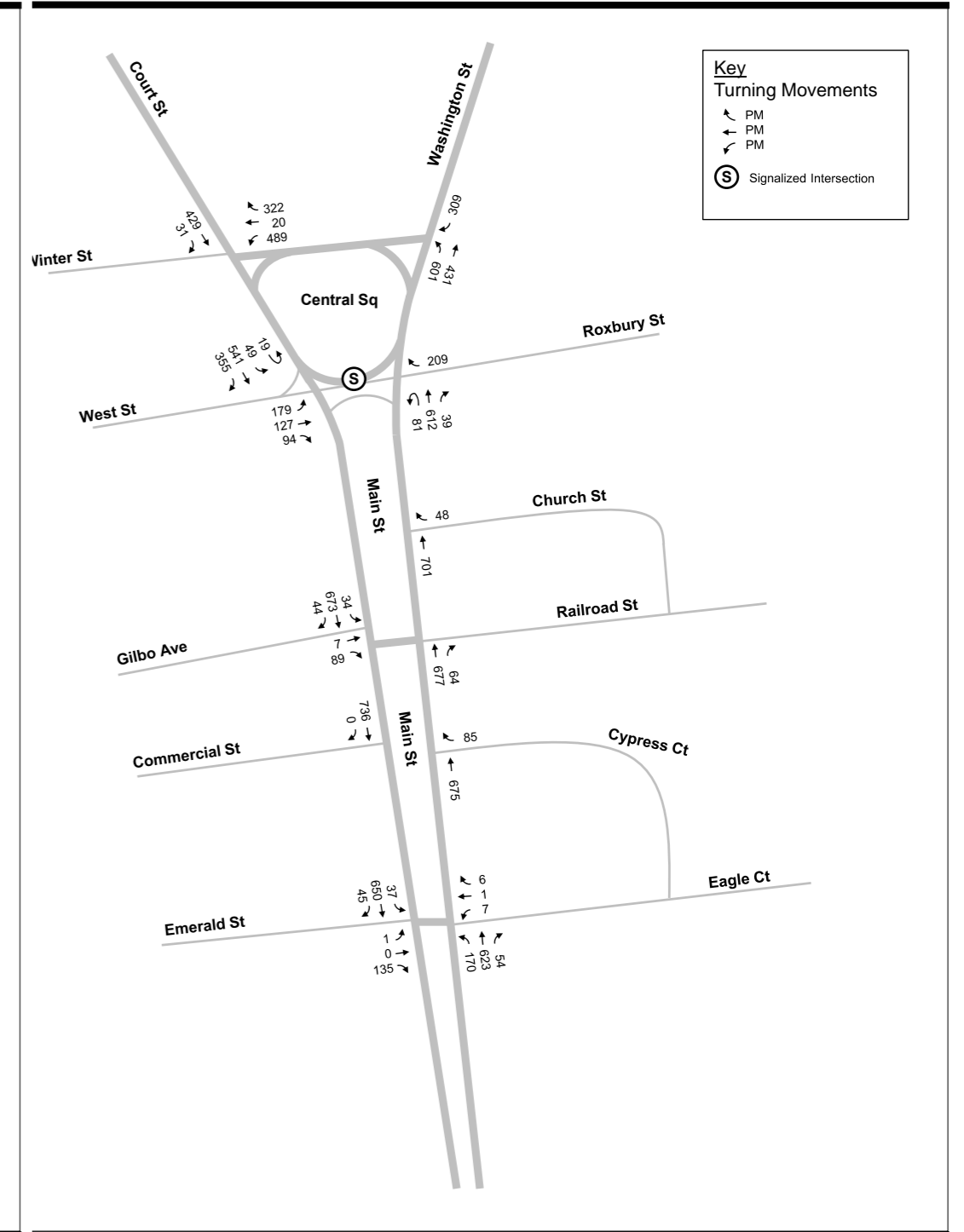
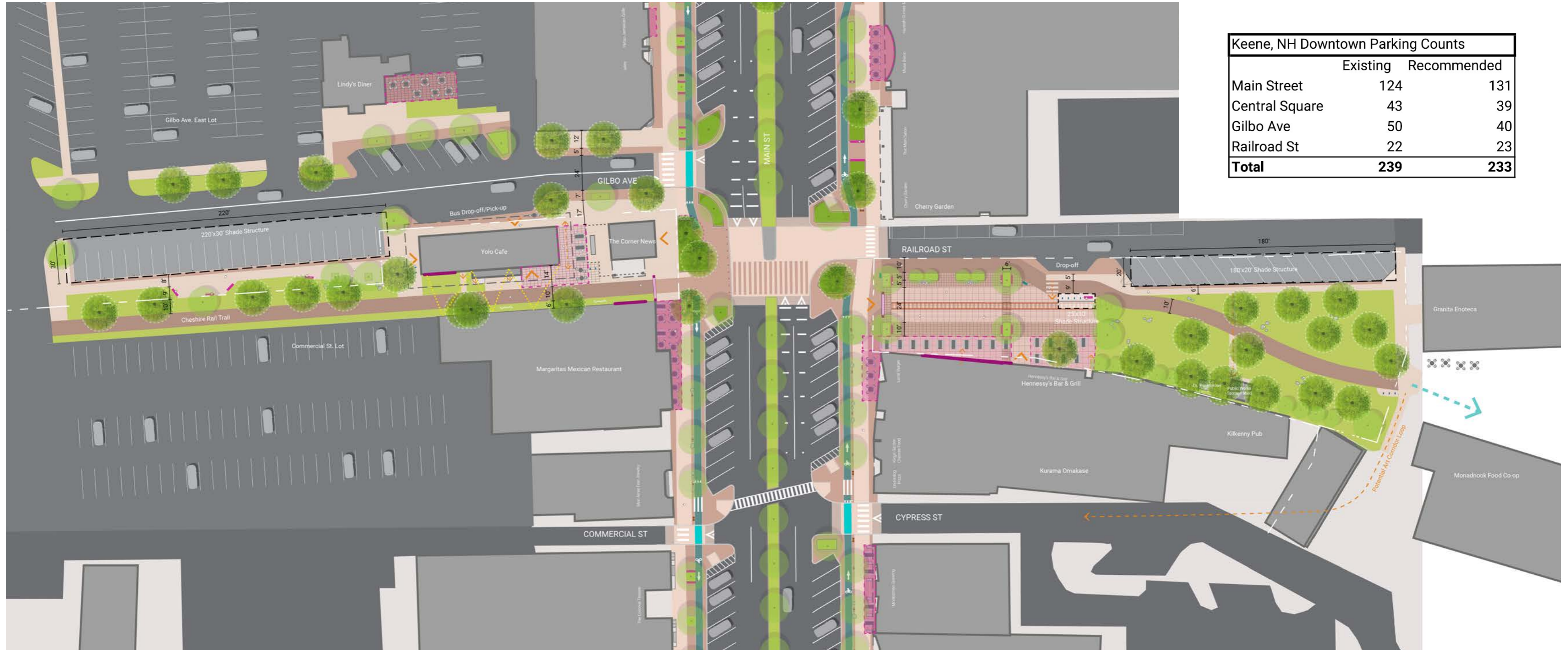

Figure 5 Schematic Diagram:  
2022 Existing PM Peak Hour Traffic Volumes

# KEENE PHASE 2 | GILBO AVE/RAILROAD SQ

## SITE PLAN - GILBO/RAILROAD



	Existing	Recommended
Main Street	124	131
Central Square	43	39
Gilbo Ave	50	40
Railroad St	22	23
<b>Total</b>	<b>239</b>	<b>233</b>



# KEENE PHASE 2 | GILBO AVE EXISTING TREE ASSESSMENT

-  GOOD CONDITION
-  FAIR CONDITION
-  POOR CONDITION

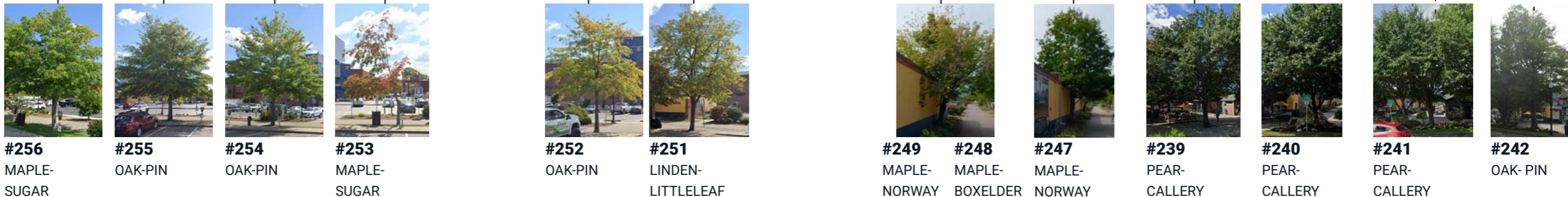
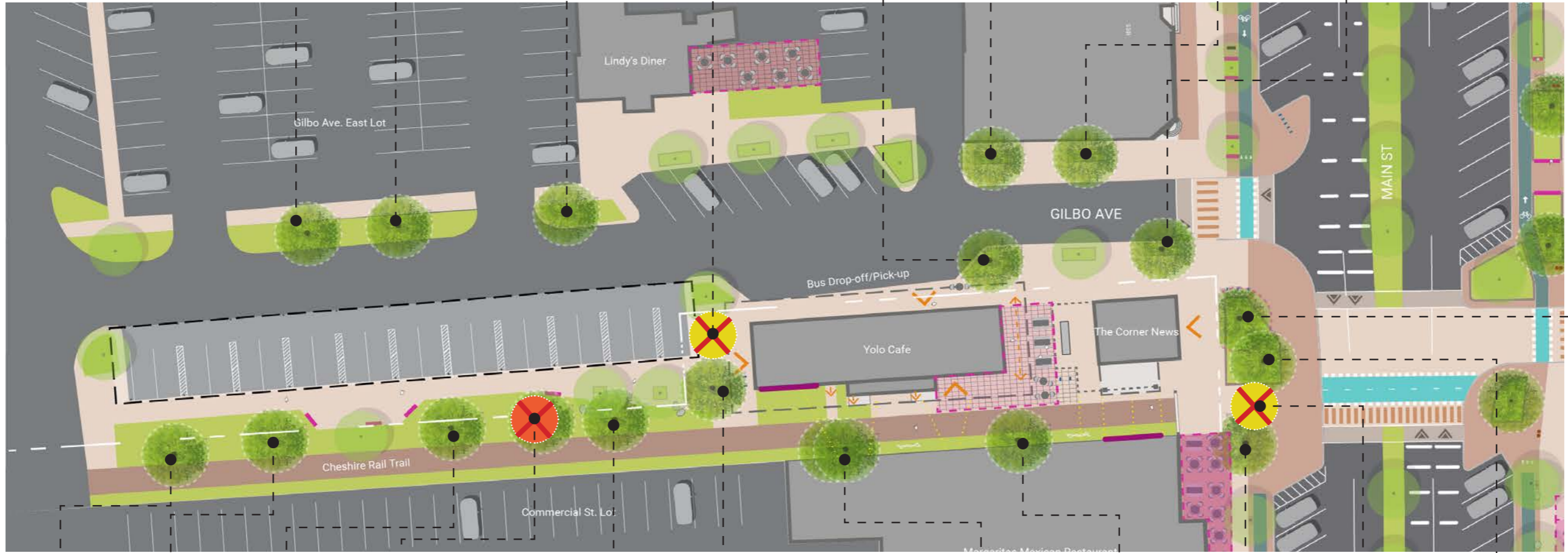
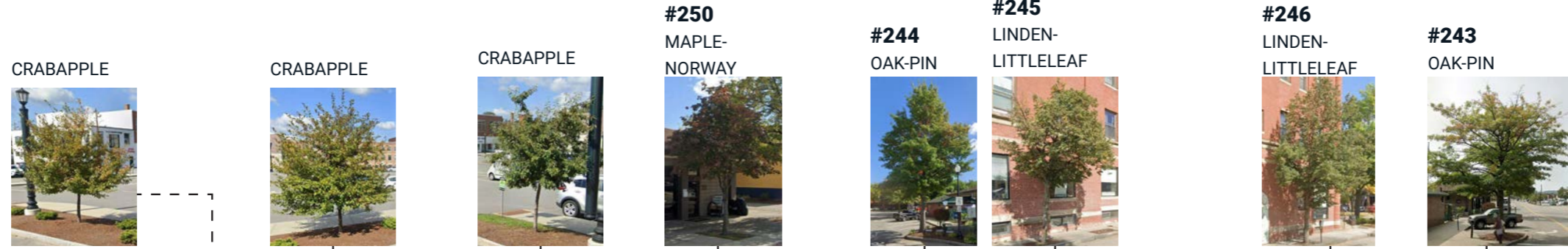

# KEENE PHASE 2 | GILBO AVE PRECEDENT IMAGES - PUBLIC RESPONSE

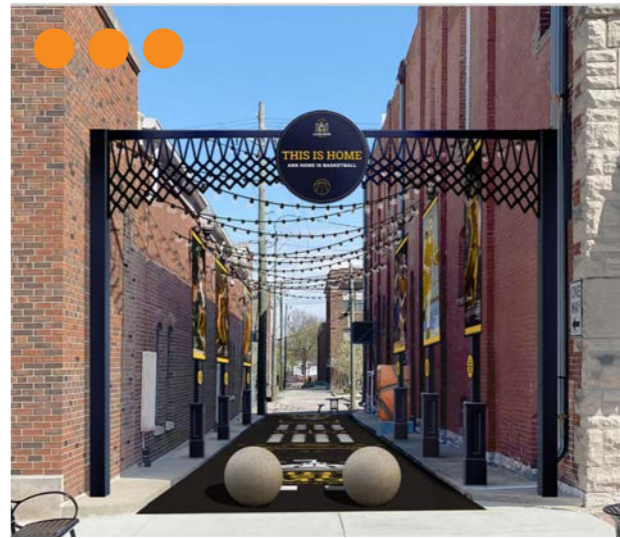
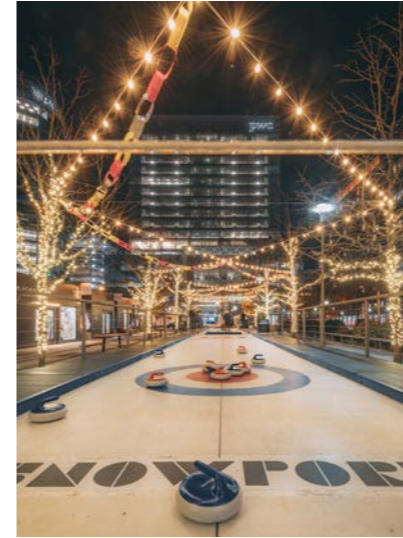

# KEENE PHASE 2 | GILBO AVE RECOMMENDED OPTION

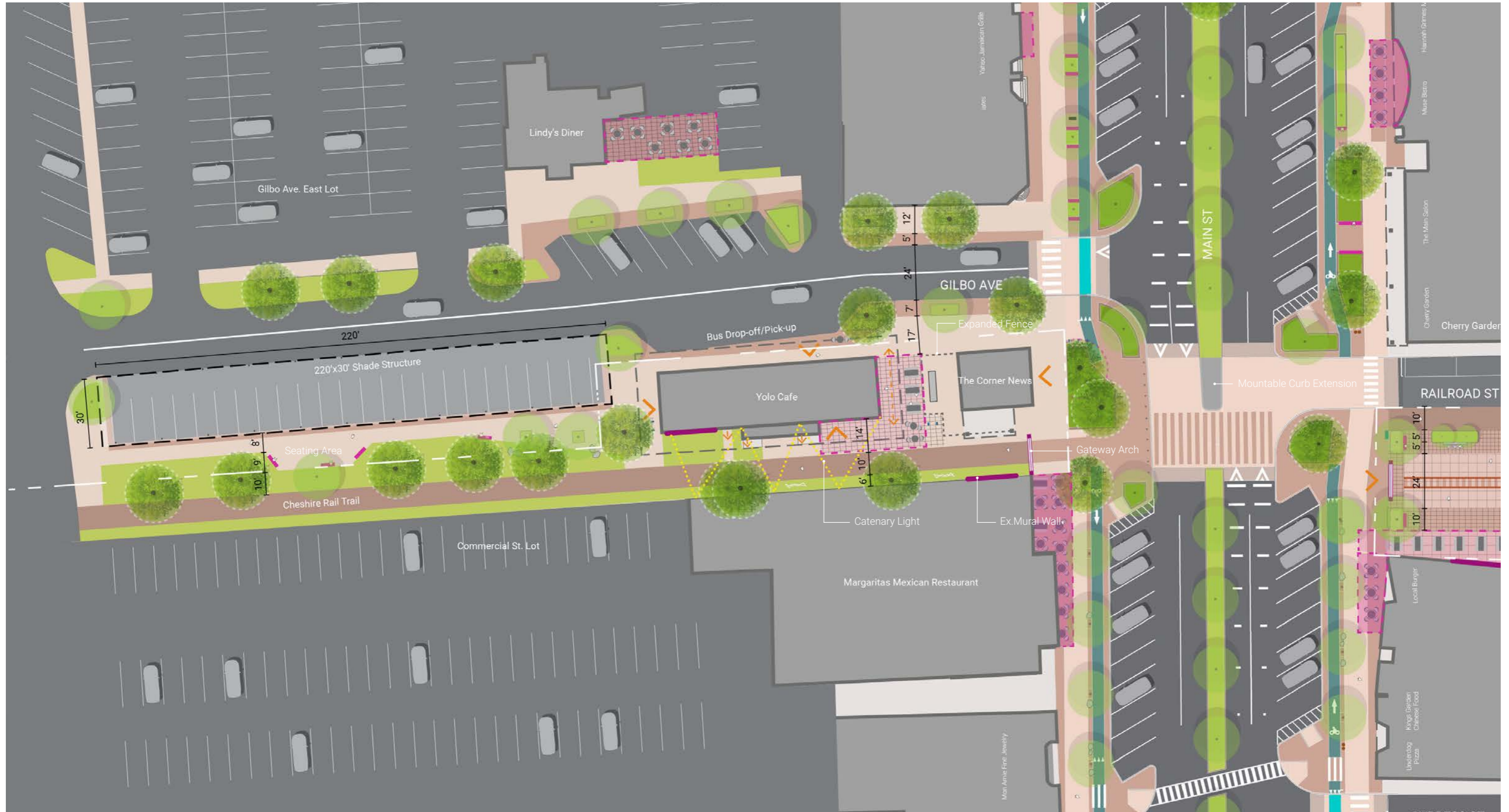

# KEENE PHASE 2 | GILBO AVE CONCEPT SECTION 1

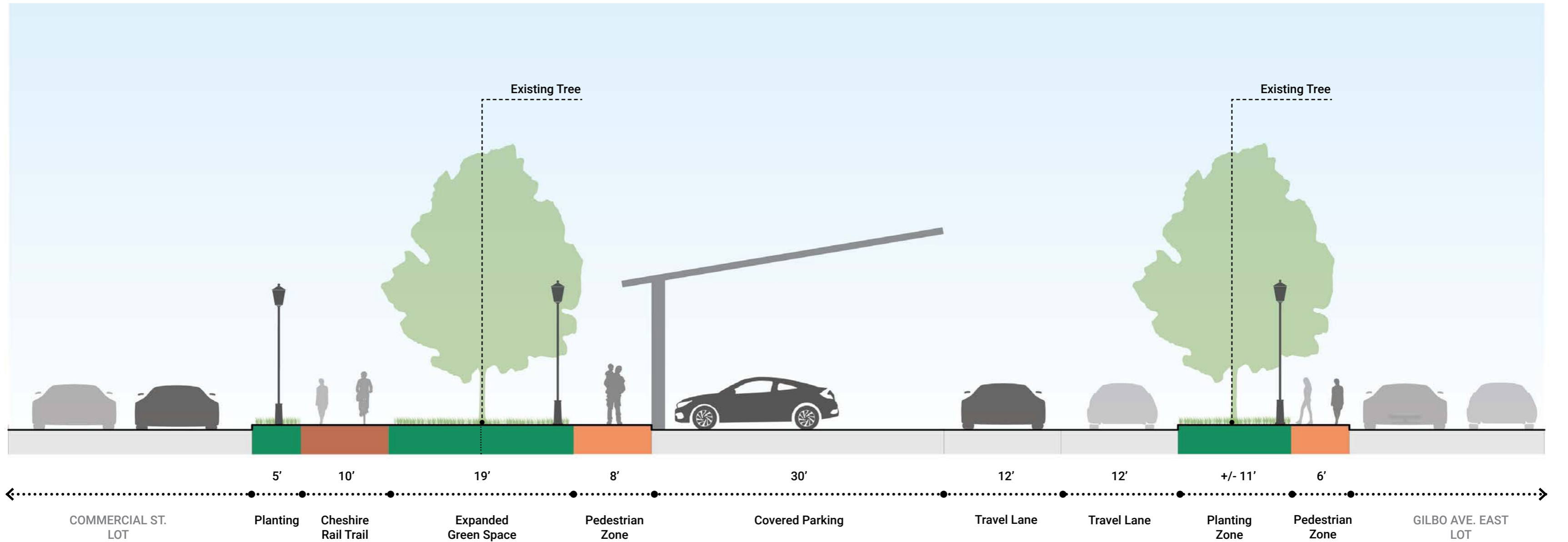

# KEENE PHASE 2 | GILBO AVE CONCEPT SECTION 2

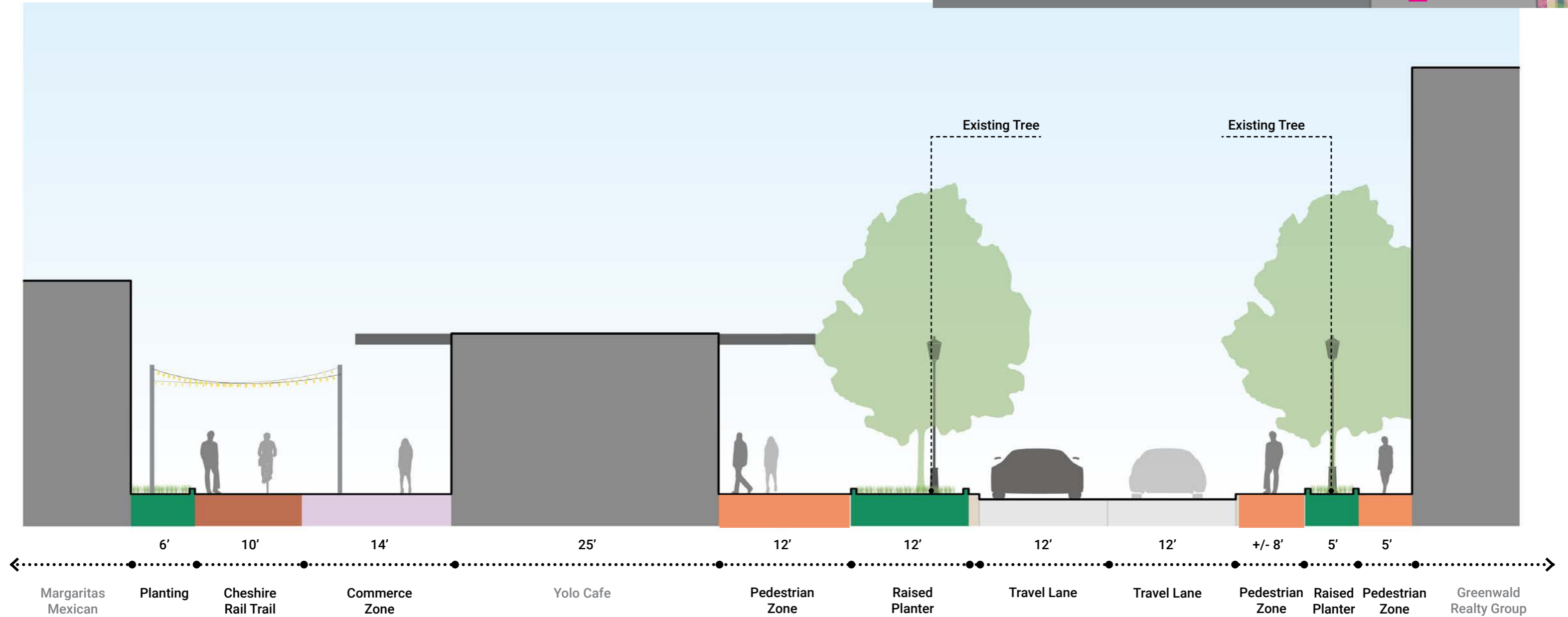
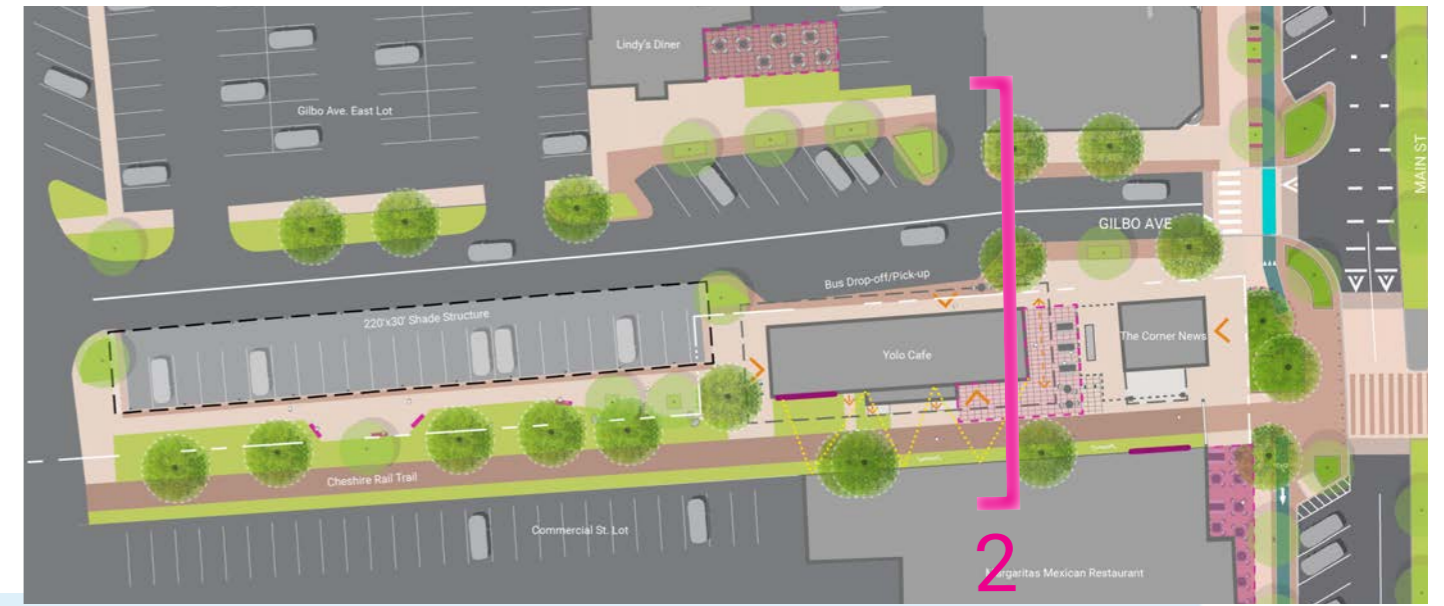

# KEENE PHASE 2 | GILBO AVE PROGRAMMING MATRIX - ART/FARMER'S MARKET

ART/FARMERS' MARKET: 30-35 VENDORS | 3-6 TENTS



# KEENE PHASE 2 | GILBO AVE PROGRAMMING MATRIX - FOOD EVENT

## FOOD EVENT: 8-11 FOOD TRUCKS



# KEENE PHASE 2 | GILBO AVE PARKING OPTIONS

RECOMMENDED OPTION

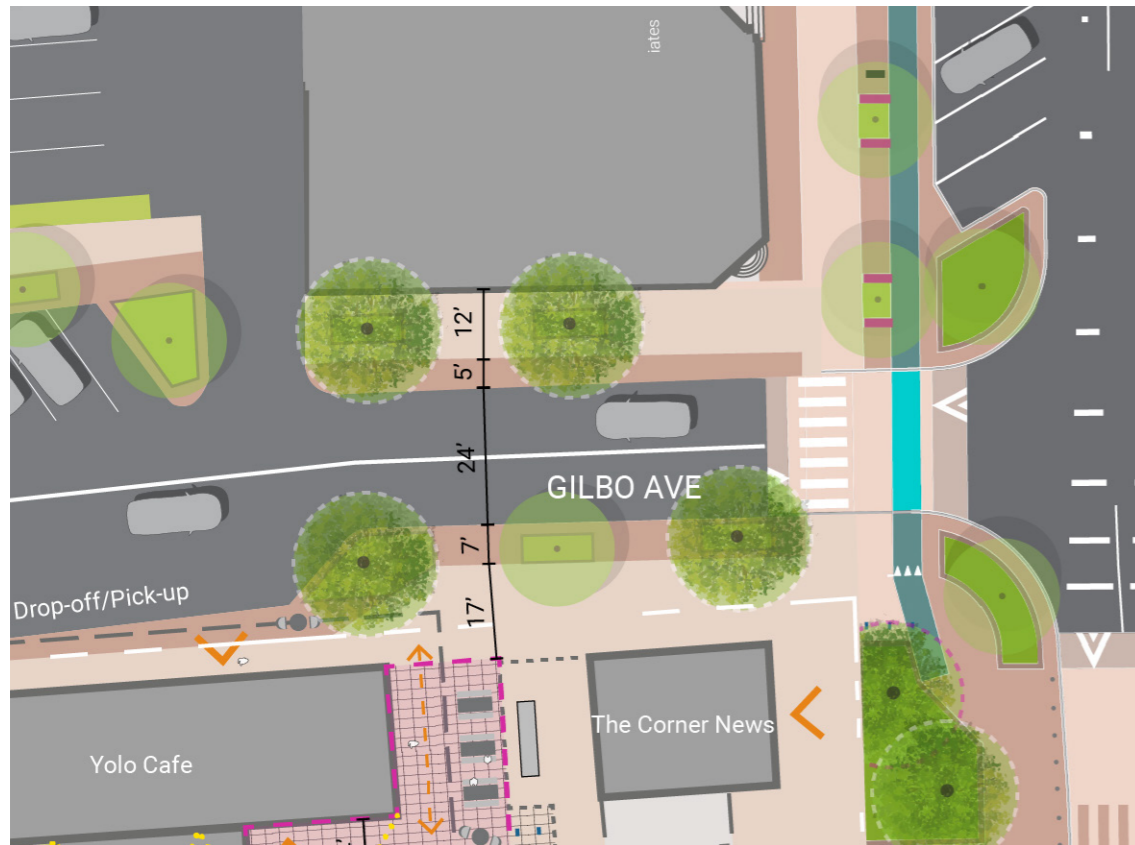

Existing Recommended

Gilbo Ave Parking Count 50 40

ALTERNATIVE OPTION 1 - MAINTAIN EXISTING PARKING



Existing Recommended

Gilbo Ave Parking Count 50 47

ALTERNATIVE OPTION 2 - PARALLEL PARKING

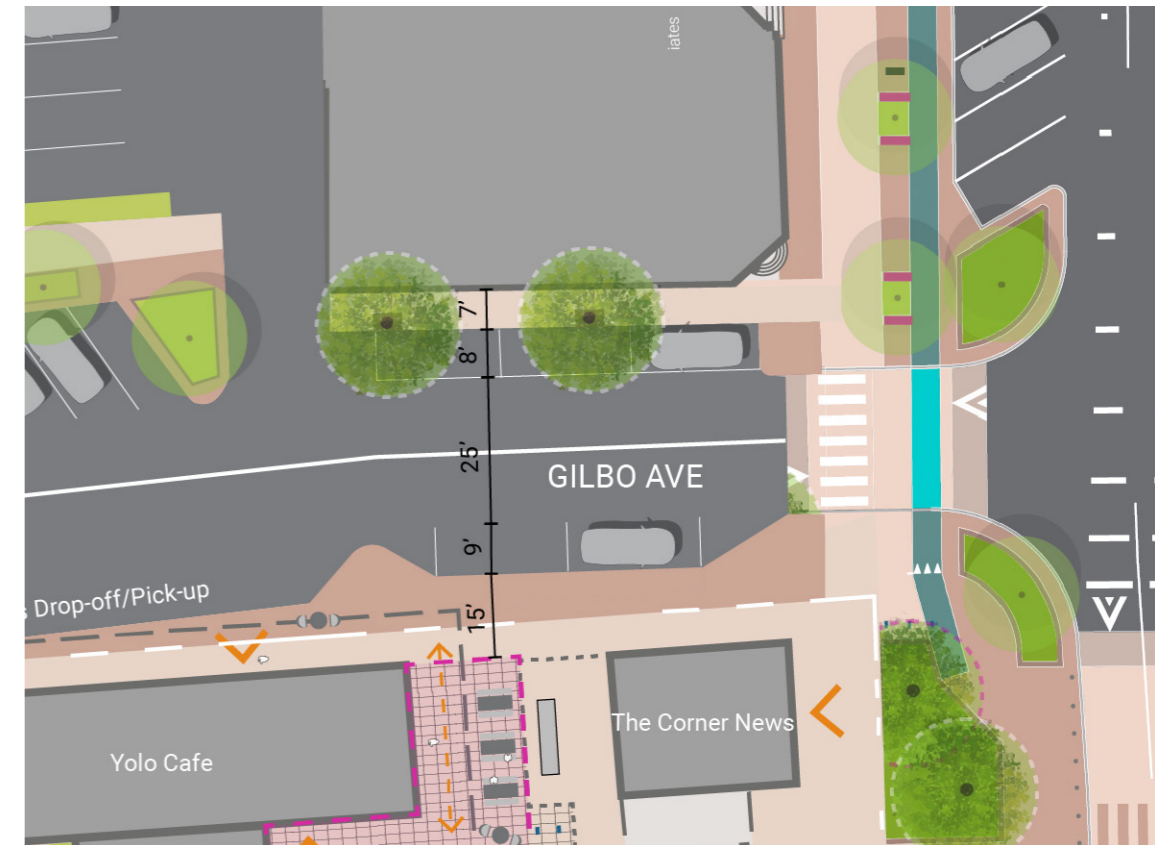

Existing Recommended

Gilbo Ave Parking Count 50 45



# KEENE PHASE 2 | GILBO AVE ALTERNATIVE OPTION - MAXIMIZING GREEN SPACE

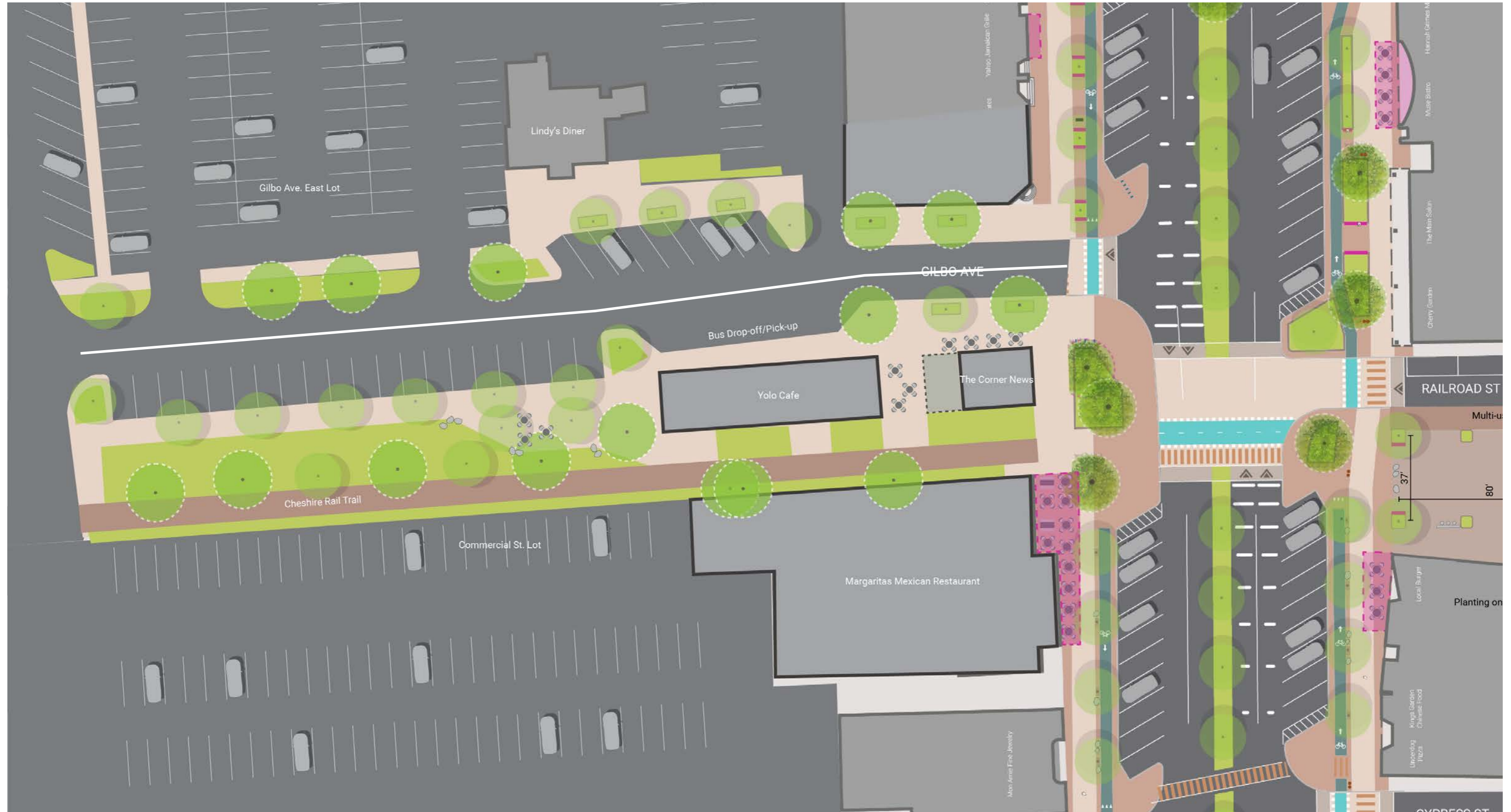

# KEENE PHASE 2 | GILBO AVE/RAILROAD SQ

## **PUBLIC WORKSHOP #2 SUMMARY**

### **Gilbo Ave**

- Positive feedback around raised intersection, solar parking structure, gateway structure, lighting, and bike racks
- Desire for keeping street parking for businesses
- Desire for public bathrooms and activating area between buildings for positive use

## **Gilbo Ave**

- Do you want to maintain parking spaces at intersection or remove to expand sidewalk/commerce space?
- Do you want covered /parking pavilion for flex space/solar opportunities?
- Do you want more permanent seating in public spaces?
- Do you want a gateway type structure to Gilbo Ave. amenities?
- Do you want to provide an option for covered bike parking in Gilbo plaza space?
- Do you want permanent catenary lighting?

# KEENE PHASE 2 | GILBO AVE/RAILROAD SQ

## SITE PLAN - GILBO/RAILROAD

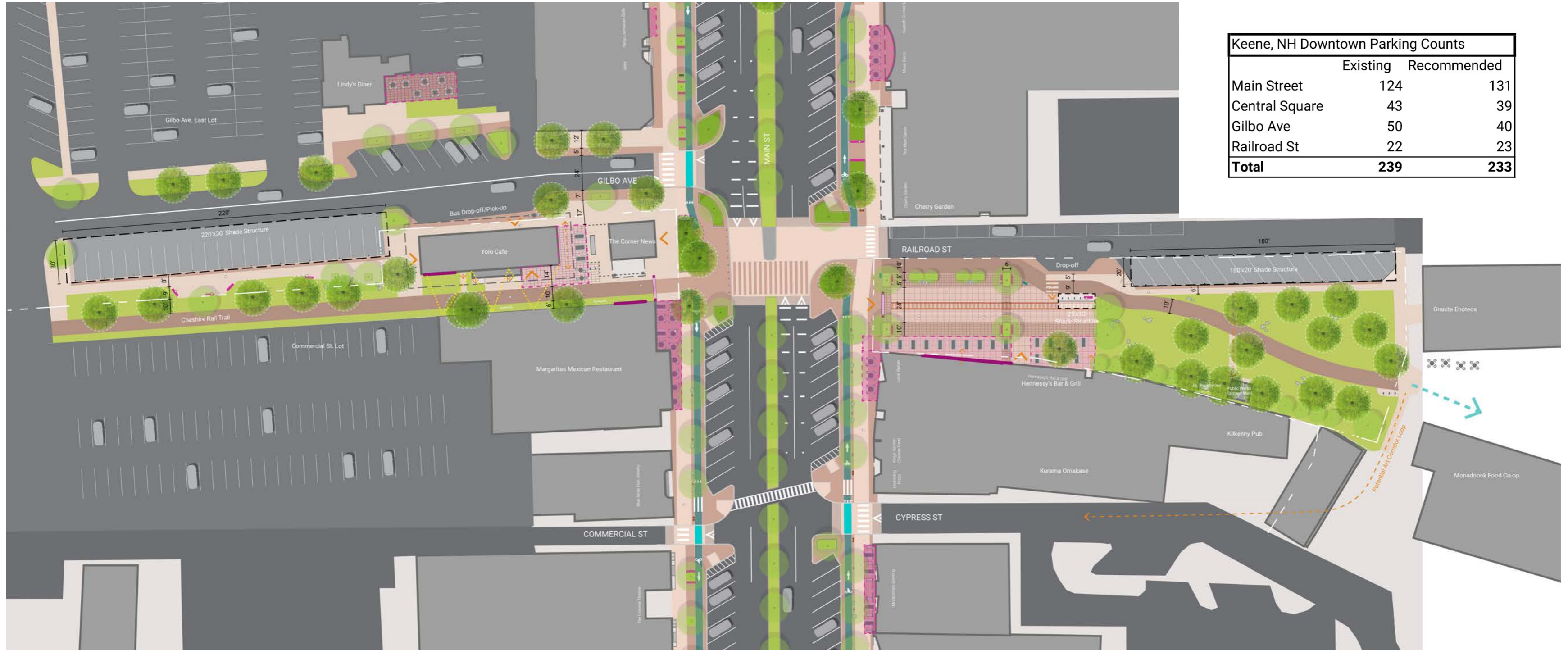

# KEENE PHASE 2 | RAILROAD SQUARE

## PRECEDENT IMAGES - PUBLIC RESPONSE

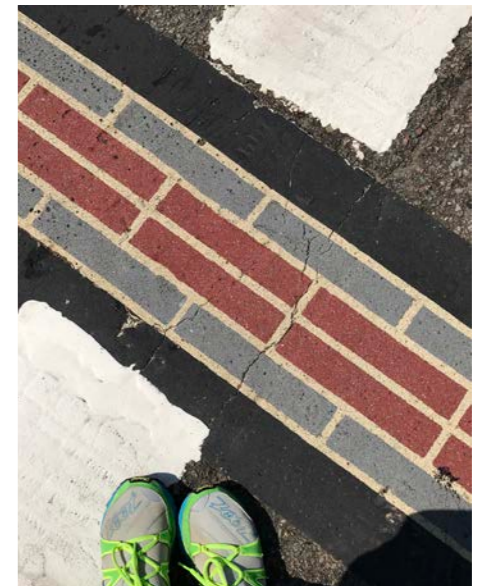
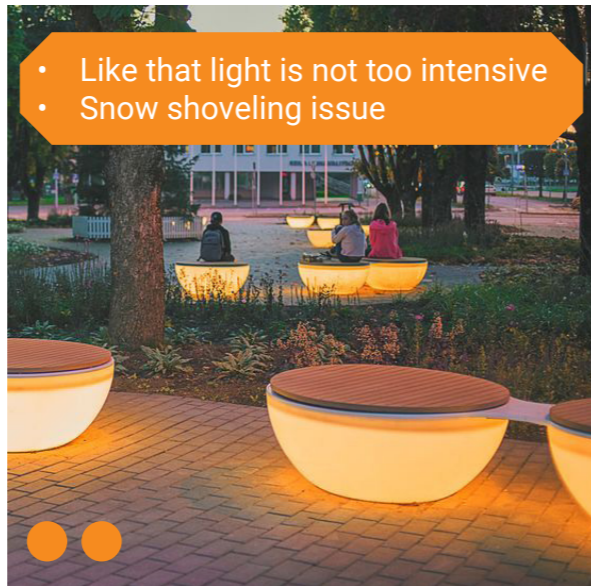
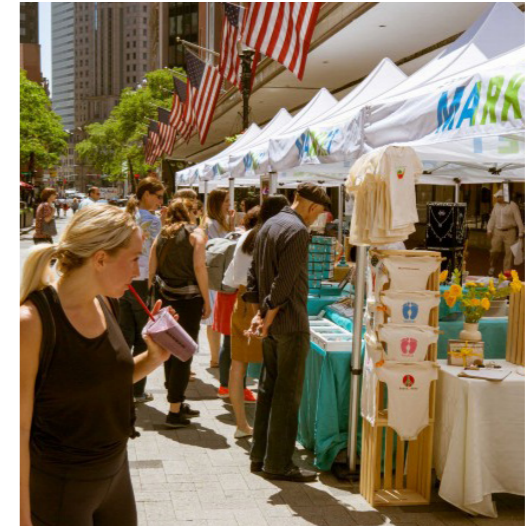
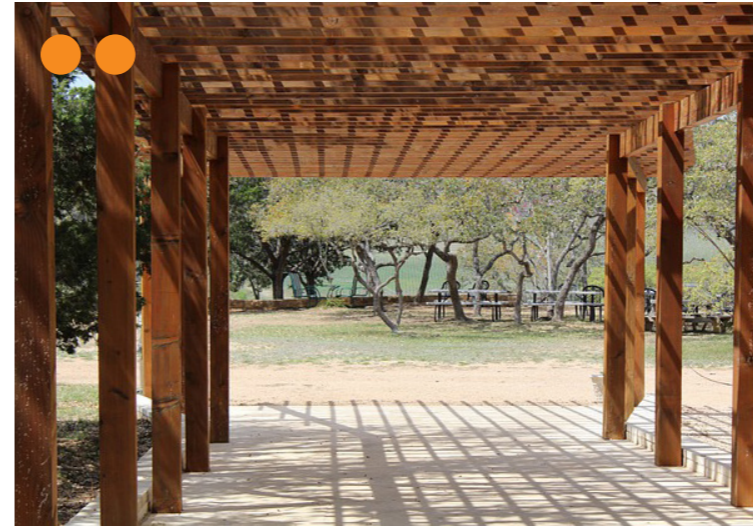

# KEENE PHASE 2 | RAILROAD SQUARE

## EXISTING TREE ASSESSMENT

-  GOOD CONDITION
-  FAIR CONDITION
-  POOR CONDITION

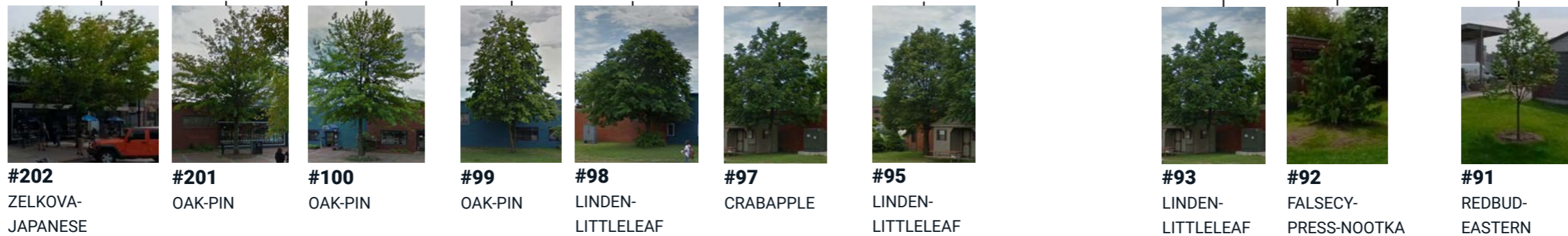
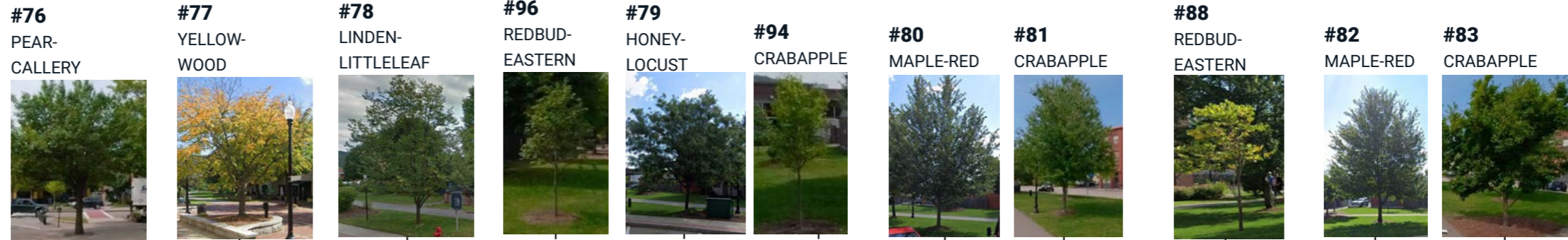

# KEENE PHASE 2 | RAILROAD SQUARE

## RECOMMENDED OPTION



# KEENE PHASE 2 | RAILROAD SQUARE CONCEPT SECTION 3 - EVENT

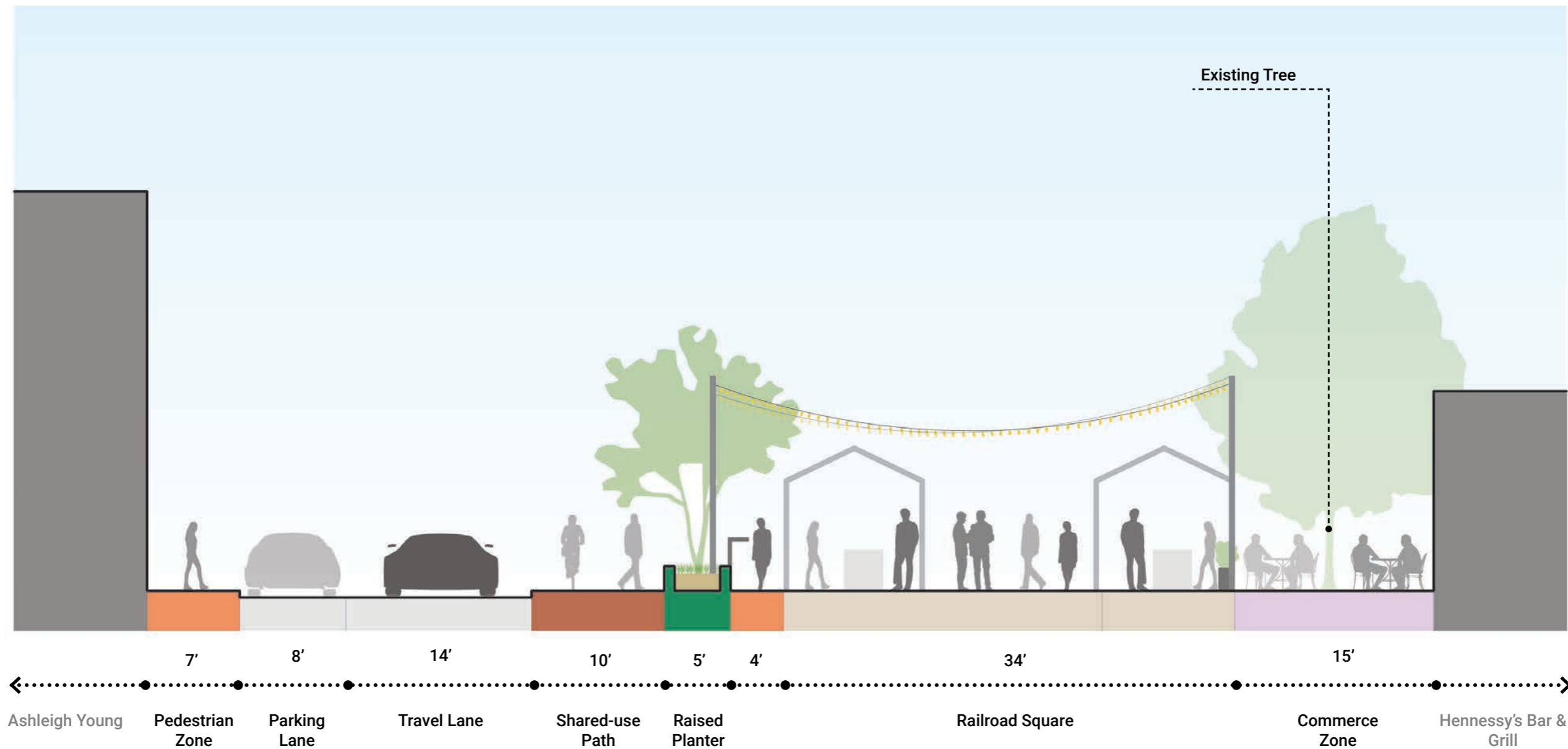
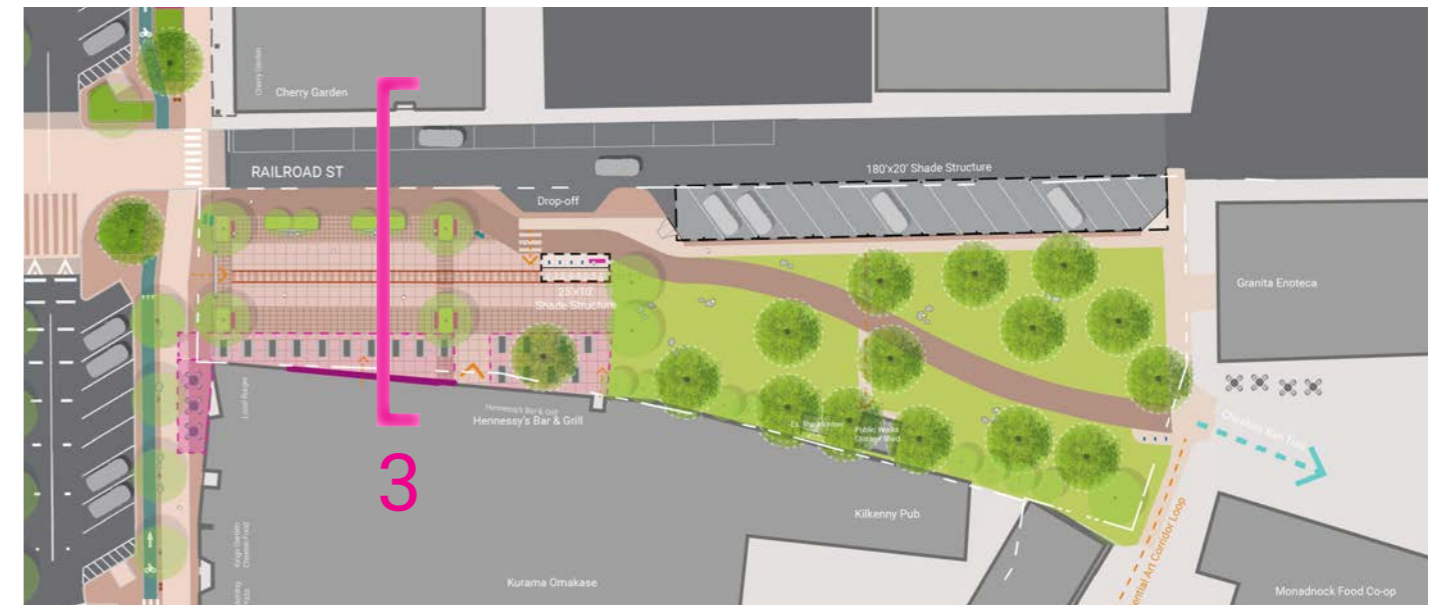



# KEENE PHASE 2 | GILBO AVE PROGRAMMING MATRIX - ART/FARMER'S MARKET

ART/FARMERS' MARKET: 30-40 TENTS | 40-64 VENDORS | 400-600 PEOPLE



# KEENE PHASE 2 | GILBO AVE PROGRAMMING MATRIX - FOOD EVENT

FOOD EVENT: 5-8 FOOD TRUCKS | 400-600 PEOPLE



# KEENE PHASE 2 | GILBO AVE PROGRAMMING MATRIX - PERFORMANCE

PERFORMANCE: 400-600 STANDING/SITTING PEOPLE

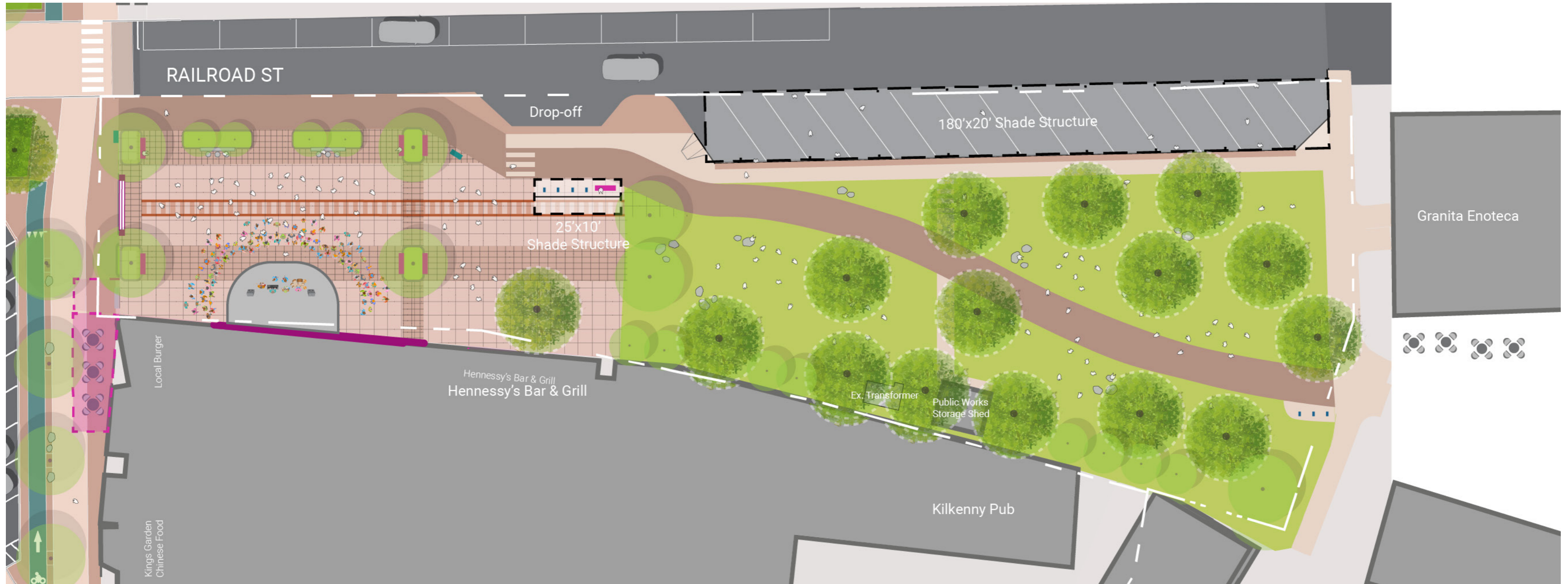

# KEENE PHASE 2 | RAILROAD SQUARE ALTERNATIVE OPTION 1 - MINIMAL



# KEENE PHASE 2 | RAILROAD SQUARE ALTERNATIVE OPTION 2 - SHADE STRUCTURE

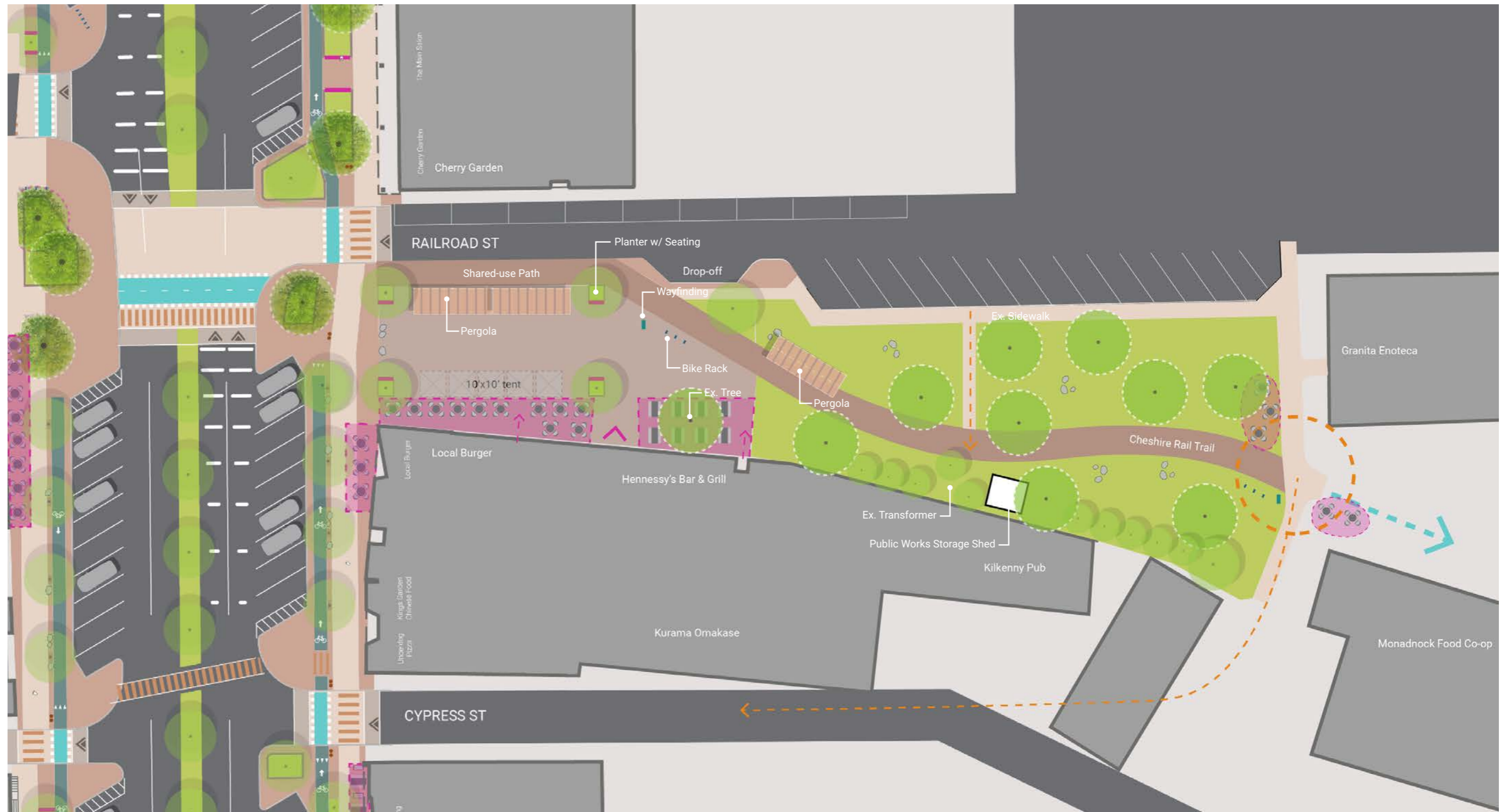

# KEENE PHASE 2 | RAILROAD SQUARE ALTERNATIVE OPTION 3 - LARGER GREEN SPACE

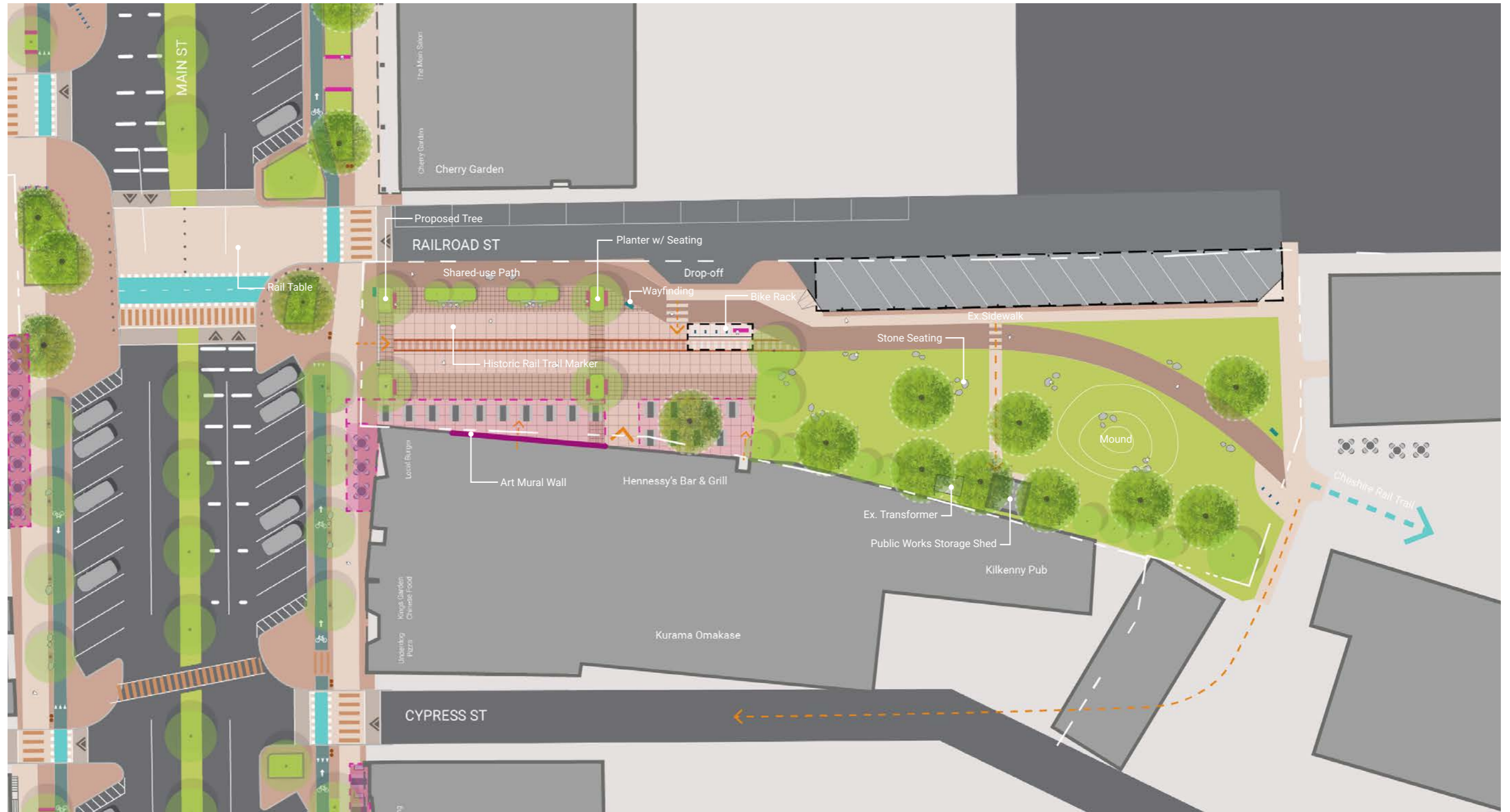

# KEENE PHASE 2 | MAIN ST STREETSCAPE REMOVAL OF LEFT TURN AT RAILROAD

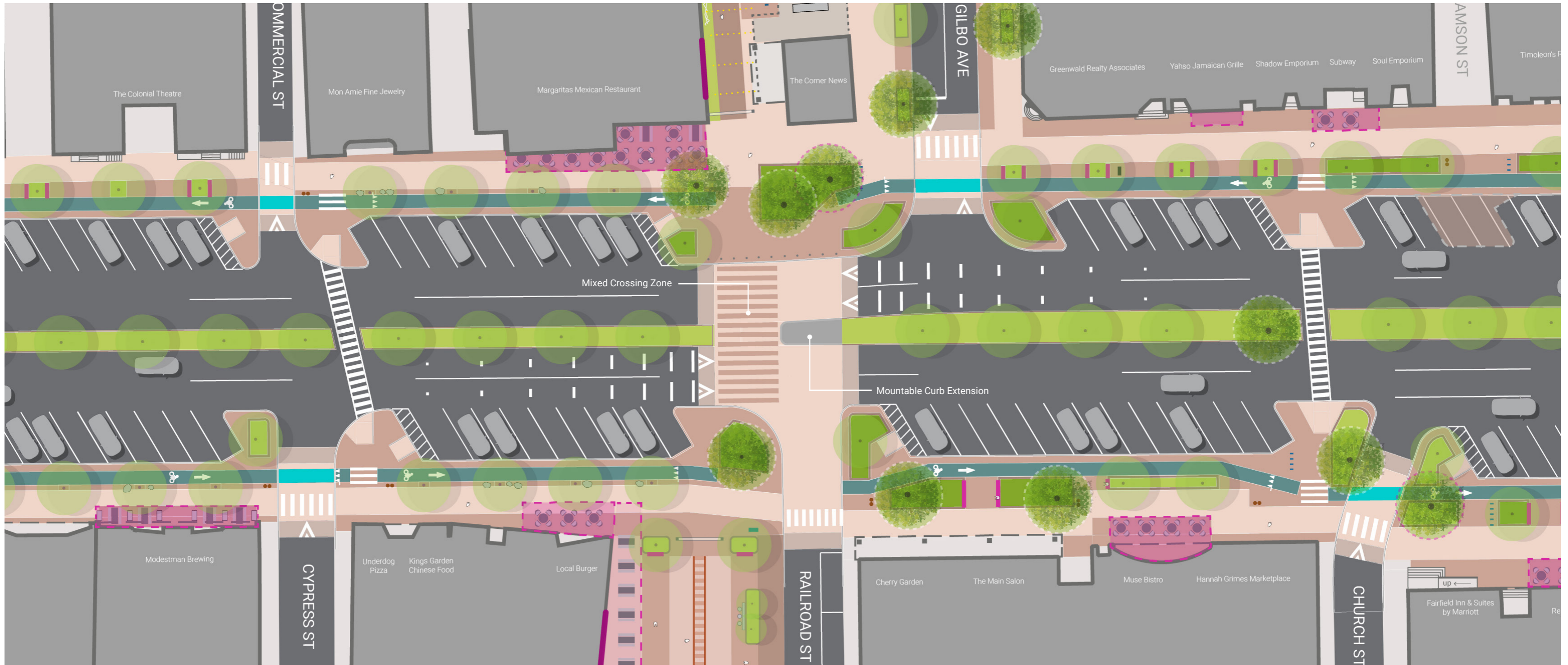

## **Railroad Square Design**

- Positive feedback on event space to promote positive activities
- Positive feedback on outdoor dining zone for surrounding restaurants to help activate space
- Positive feedback around covered bike parking, pergola, catenary light, gateway structure, solar parking structure
- Support for integrating more art via mural, historic remnant, sculpture
- Concerns about cyclist/pedestrian conflict on shared-use path
- Concerns about bike lane transition from Gilbo through raised intersection to Railroad
- Concerns about visibility at Main St/Railroad turning
- Desire for bollards at raised intersection
- Desire for clear signs of allowed bike zone
- Desire to maintain existing trees in green space and adding topography where feasible



# KEENE PHASE 2 | GILBO AVE/RAILROAD SQ

## DESIGN DECISION

### Railroad Square

- Do you have a preference to the location of shared path?
- Do we want expanded commerce areas in RR Square?
- Do you want a mounded landscape area?
- Do we want a solar structure?
- If only one location is preferred, do you have a priority?
- Do you have a preference on material treatments in RR Square?
- Do you want a gateway type structure to the RR Square plaza?
- Do you want to provide an option for covered bike parking in RRS plaza?
- Do you want more permanent seating in public spaces?
- Should left turn access be maintained? This may require reducing the size of raised crosswalk.
- Should left turn access be used only by emergency vehicles? A mountable curb island can be provided.
- Do we want to relocate the Walldogs Informational Signage to improve view and safety of pedestrians crossing northbound on Railroad St?

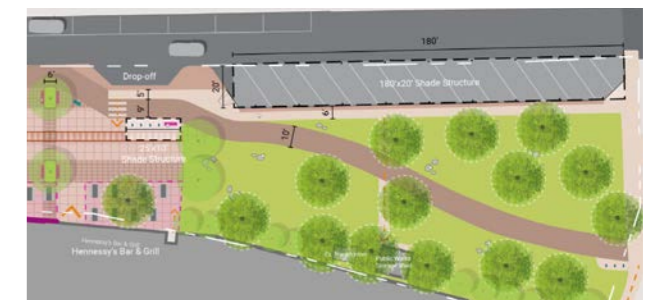
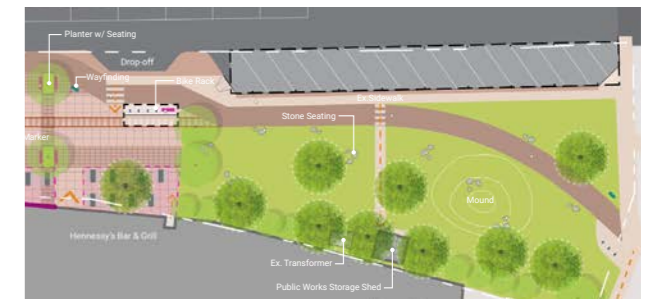

# KEENE PHASE 2 | MAIN STREET STREETSCAPES

## SUSTAINABLE PRECEDENTS - PUBLIC RESPONSE

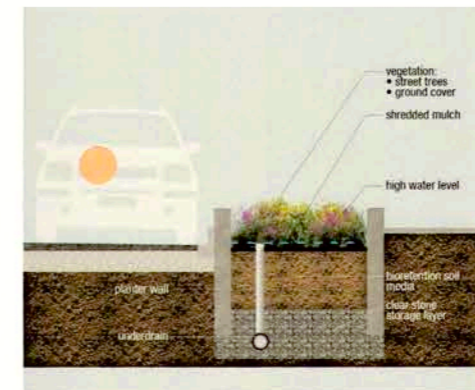
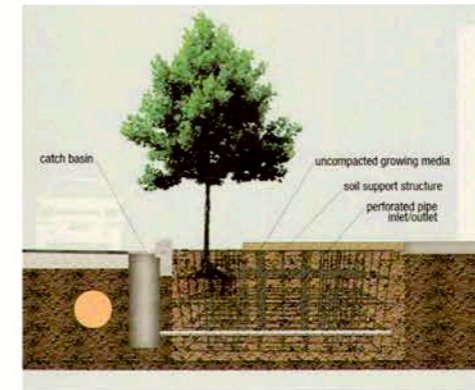
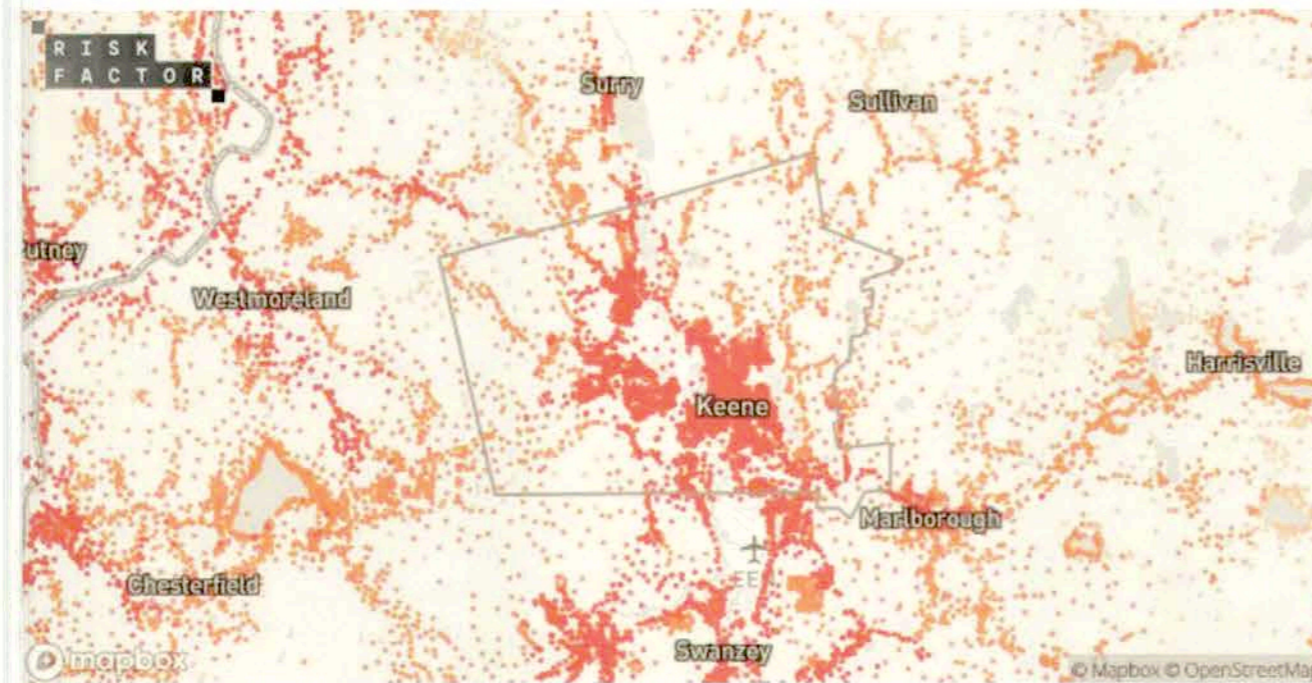

Stormwater Collectio



Solar Street Light

**Stormwater Tree Pit Inlet**

1. Trees filter and transpire stormwater while providing shade and enhancing the streetscape.
2. Stormwater travels both vertically and horizontally into system.
3. Underdrain (if needed).
4. Stone (or other storage media) provides stormwater storage.
5. Stormwater infiltrates through soil.
6. Stormwater infiltrates into subgrade.
7. Uncompacted, level subgrade.
8. Overflow limits amount of surface ponding.

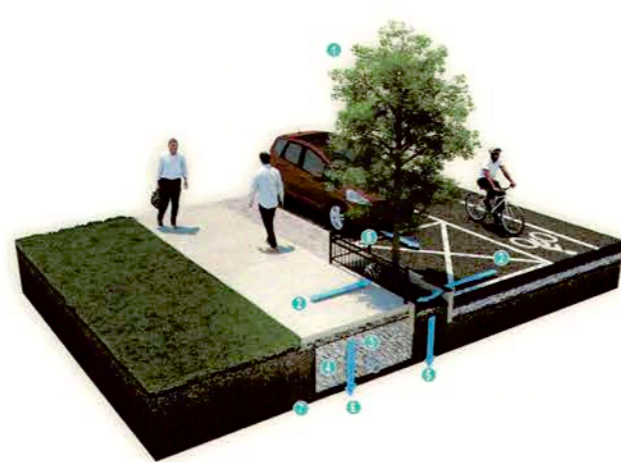

**Corner Stormwater Bump-out**

1. Vegetation filters and evaporates stormwater while enhancing the streetscape.
2. Stormwater runoff from roadway and sidewalk flows into system.
3. Overflow limits amount of surface ponding.
4. Stone (or other storage media) provides stormwater storage.
5. Underdrain (if needed).
6. Stormwater infiltrates into subgrade.
7. Uncompacted, level subgrade.



Solar Structure over Parking

Source: UNI-Group U.S.A  
[https://www.uni-groupusa.org/PDF/Grey-to-Green-Road-ROW-Retrofits-Complete\\_1.pdf](https://www.uni-groupusa.org/PDF/Grey-to-Green-Road-ROW-Retrofits-Complete_1.pdf)

# KEENE PHASE 2 | MAIN STREET STREETSCAPES

## SUSTAINABLE PRECEDENTS - PUBLIC RESPONSE



Union Square, Somerville, MA



Permeable pavement parking lane  
Stormwater planter

Stormwater tree trench  
Stormwater curb extension  
Bicycle lane

Source: National Association of City Transportation Officials  
<https://nacto.org/publication/urban-street-stormwater-guide/stormwater-elements/green-infrastructure-configurations/stormwater-curb-extension/>

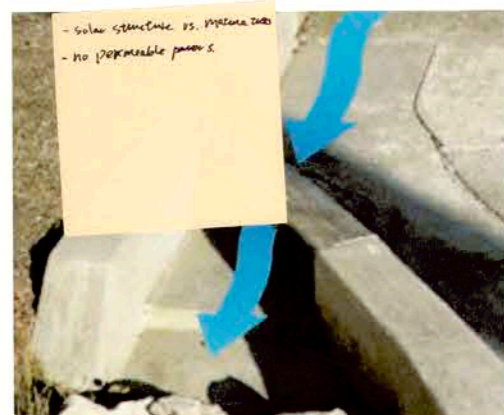

Metal extension inlet structure provides a wide opening for stormwater flow

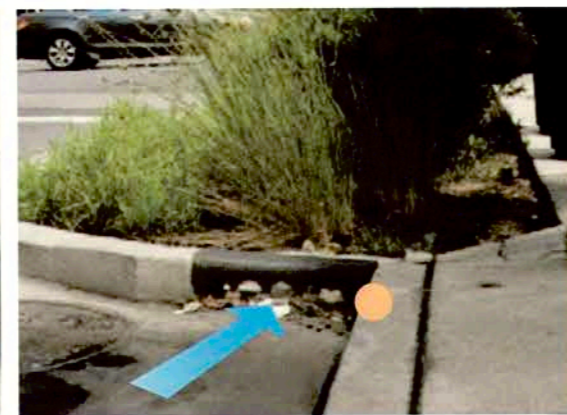

A grated inlet prevents large floatable trash



Bioswale separates sidewalks from bike lanes and vehicular traffic



An angled curb cut with a graded

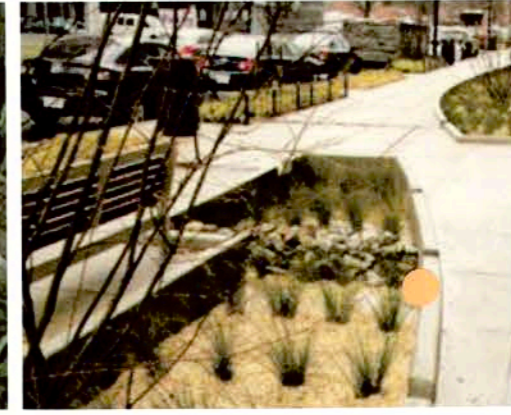

Bioretention cell in sidewalk with seating along a commercial corridor



# Keene Downtown Infrastructure Project

## SUSTAINABLE STREETSCAPE PRECEDENTS



## **Sustainable Streetscape Design**

- Positive feedback on sustainable strategies
- Concerns about solar light post conflicting with mature trees

### DESIGN REVIEW WORKSHOPS

MARCH

**06** WED  
3-4:30PM & 5:30-7PM

DESIGN AREA 1: **Main St. Streetscape**

APRIL

**10** WED  
3-4:30PM & 5:30-7PM

DESIGN AREA 2: **Gilbo Ave./Railroad Sq.**

MAY

**01** WED  
3-4:30PM & 5:30-7PM

DESIGN AREA 3: **Central Square**

**AT** Keene Recreation Center  
312 Washington St., Room 14

### MSFI COMMITTEE MEETINGS

MARCH

**13** WED  
5:30PM

DESIGN AREA 1: **Main St. Streetscape**

APRIL

**24** WED  
5:30PM

DESIGN AREA 2: **Gilbo Ave./Railroad Sq.**

MAY

**08** WED  
5:30PM

DESIGN AREA 3: **Central Square**

**AT** City Hall, Council Chambers  
*scan live-streaming QR code:*

